

○ Avec ou sans mécanique  
 With or without mechanical elements  
 Con o senza parti meccaniche  
 Mit oder ohne Aggregate  
 Con ó sin mecanica desmontada

**CHRYSLER**

REP.	REFERENCE	PDS	NB	MZ
1	845.7001	3,0	1	260
2	845.7002	3,0	1	260
3	845.7003	3,0	1	260
4	845.7004	3,0	1	260
5	845.7005	2,7	1	200
6	845.7006	1,7	1	602
7	845.7007	1,7	1	601
9	845.7009	4,7	1	142
10	845.7010	4,7	1	141
11	845.7011	4,2	1	080
12	845.7012	4,2	1	080
13	845.7013	1,0	4	
14	845.7014	0,1	4	
15	845.7015	3,3	1	140
16	845.7016	3,3	1	140
17	845.7017	2,5	1	140
18	845.7018	2,5	1	140
19	845.7019	4,5	1	080
20	845.7020	4,5	1	080
21	845.7021	1,7	1	200
22	845.7022	1,7	1	200
23	845.7023	4,5	1	260
24	845.7024	4,5	1	260
25	845.7025	3,6	1	200
26	845.7026	3,6	1	200
	E.07	0,1	4	

	M 10-35	4
	M 10-90	4
	M 12-30	8
	M 12-35	4
	M 12-50	2
	M 18-60	2

	M 18	2
--	------	---

**845.300**

82 Kg    05.06.2000    442-D-7A

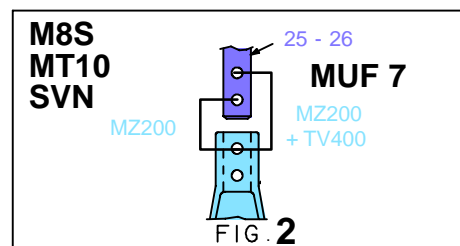
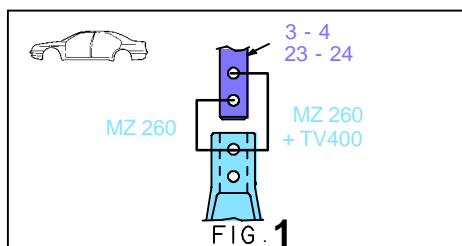
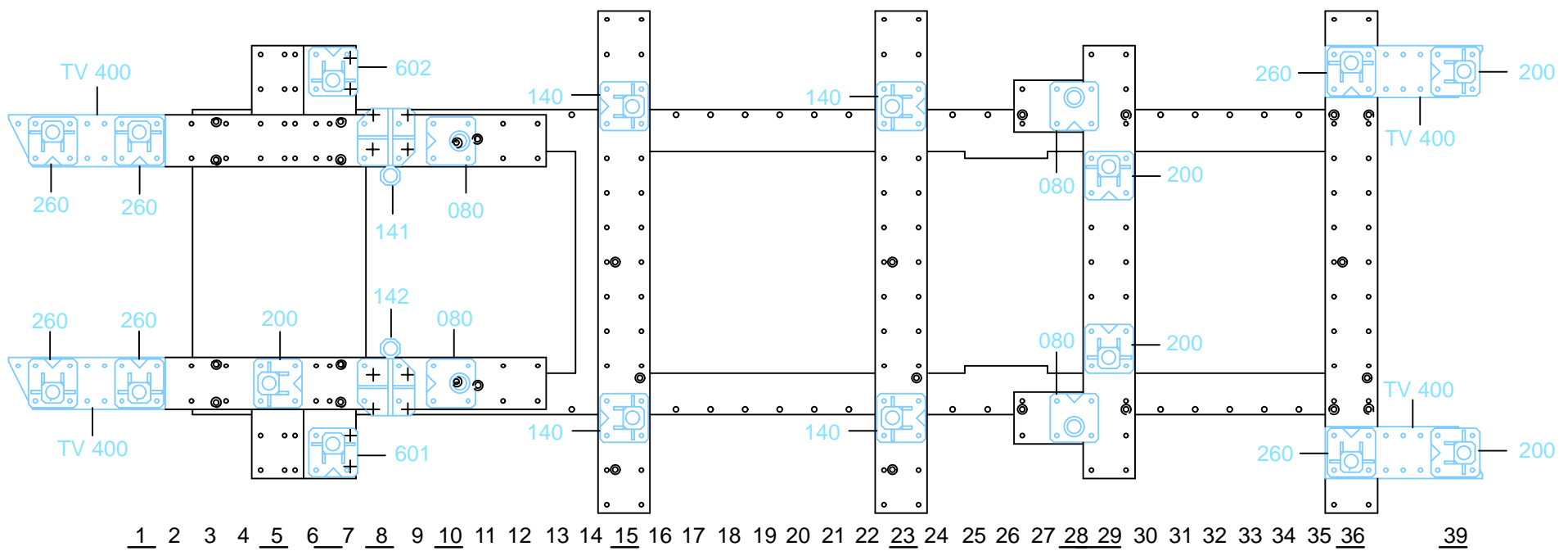

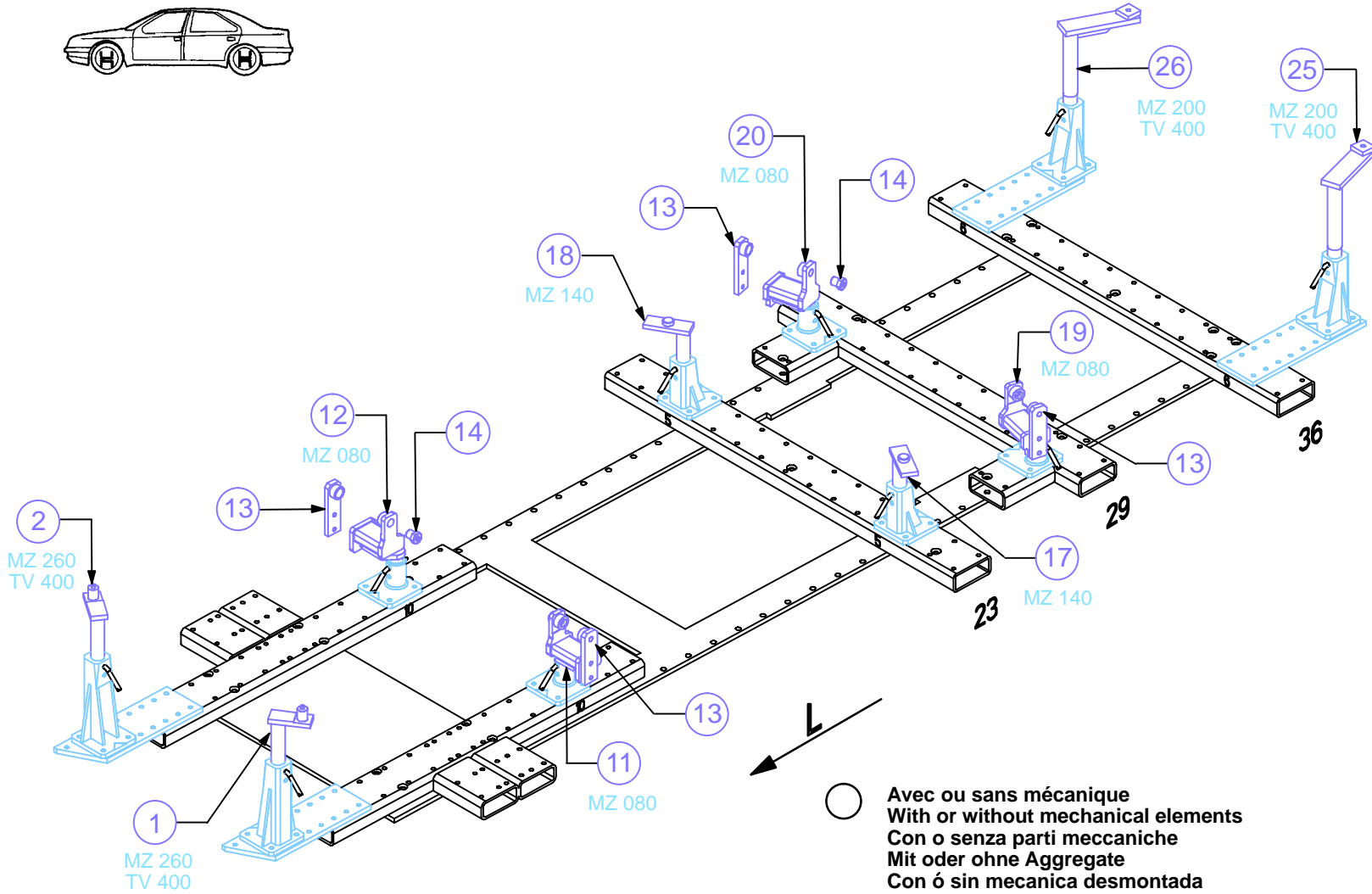
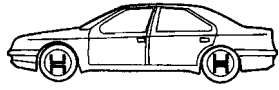

○ Avec ou sans mécanique  
 With or without mechanical elements  
 Con o senza parti meccaniche  
 Mit oder ohne Aggregate  
 Con ó sin mecanica desmontada

**CHRYSLER**

**845.300**

82 Kg | 05.06.2000 | 442-D-7B

