

**VAS 5195**



REP.	REFERENCE	PDS	NB	MZ
1	813.7001	2,9	1	200
2	813.7002	2,9	1	200
3	813.7003	0,02	4	
4	813.7004	4,2	1	260
5	813.7005	3,6	1	260
6	813.7006	1,4	1	260/080
7	813.7007	1,4	1	260/080
8	813.7008	0,4	2	
9	813.7009	1,1	2	
10	813.7010	3,6	1	602
11	813.7011	3,6	1	601
13	813.7013	2,1	1	
14	813.7014	2,1	1	
15	813.7015	2,0	1	140/080
16	813.7016	2,0	1	140/080
17	813.7017	0,2	2	
18	813.7018	4,1	1	
19	813.7019	4,1	1	
20	813.7020	0,9	2	
21	813.7021	2,4	1	140
22	813.7022	2,4	1	140
23	813.7023	3,2	1	141
24	813.7024	3,2	1	142
25	813.7025	2,5	1	601
26	813.7026	2,5	1	602
27	813.7027	2,0	1	200
28	813.7028	2,0	1	200
29	813.7029	4,5	1	
30	813.7030	4,5	1	
	D.076	0,5	2	
	B.76	0,1	2	
	B.31	0,3	2	

M 8-25	5
M 8-30	8
M 8-40	1
M 8-45	4
M 10-30	4
M 10-65	4
M 10-90	4
M 12-25	6
M 12-40	2
M 12x1,50-110	2
M 8	4

**813.300**

78 Kg | 14.03.2000 | 403-D-14A

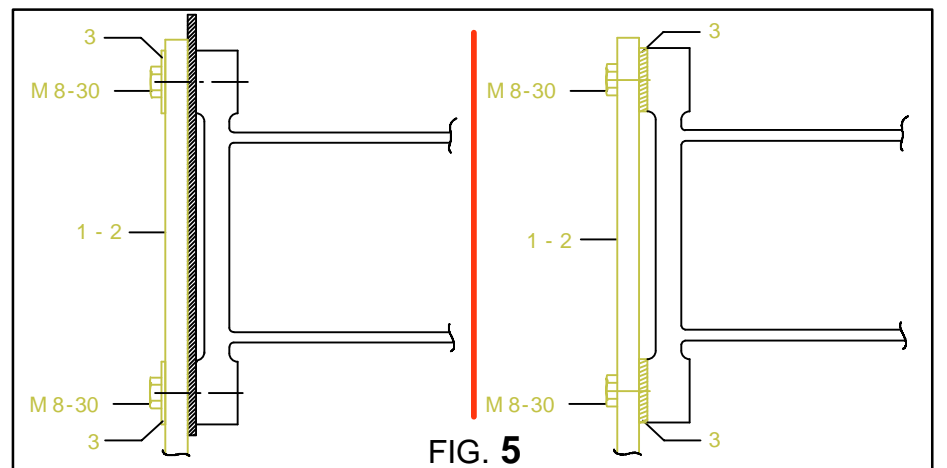
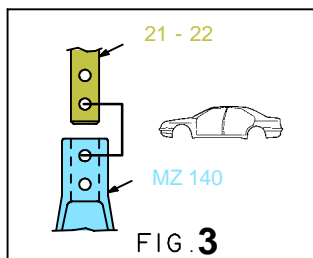
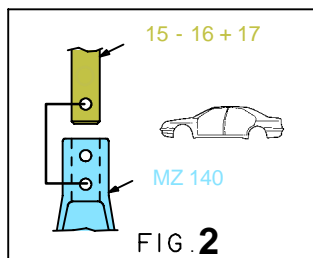
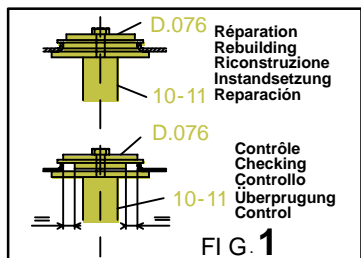
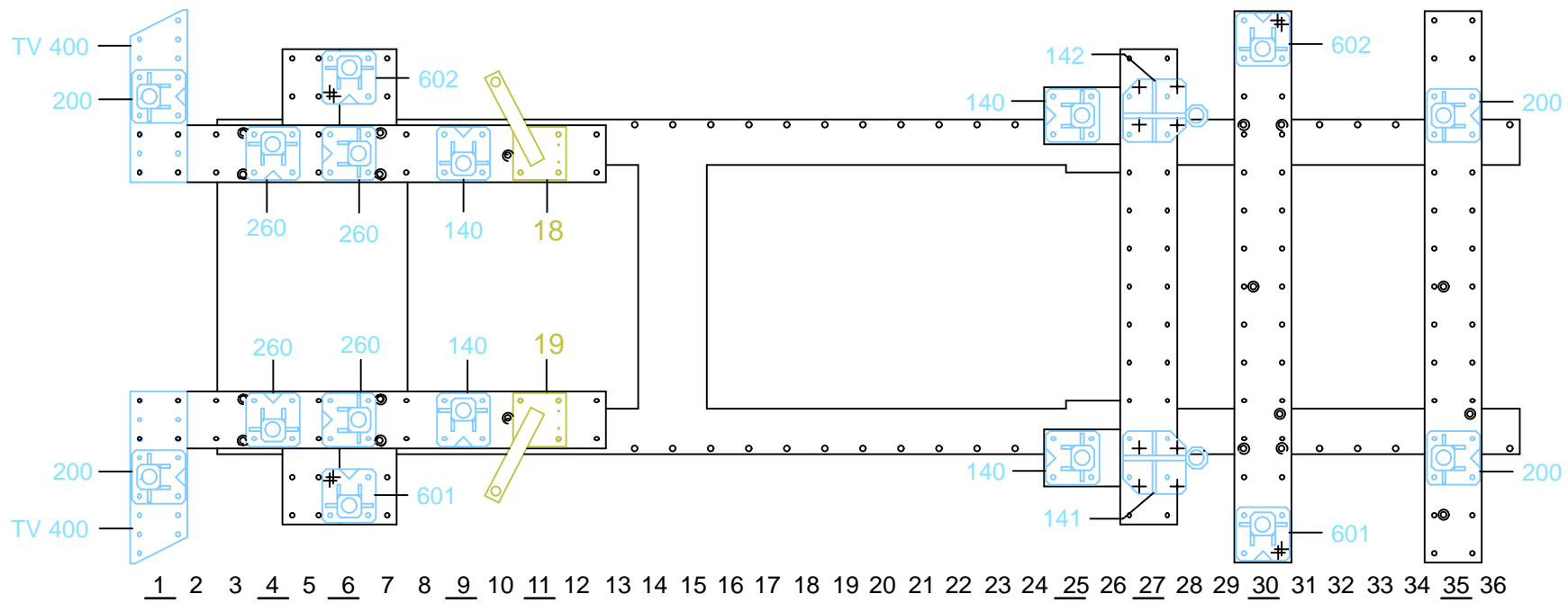

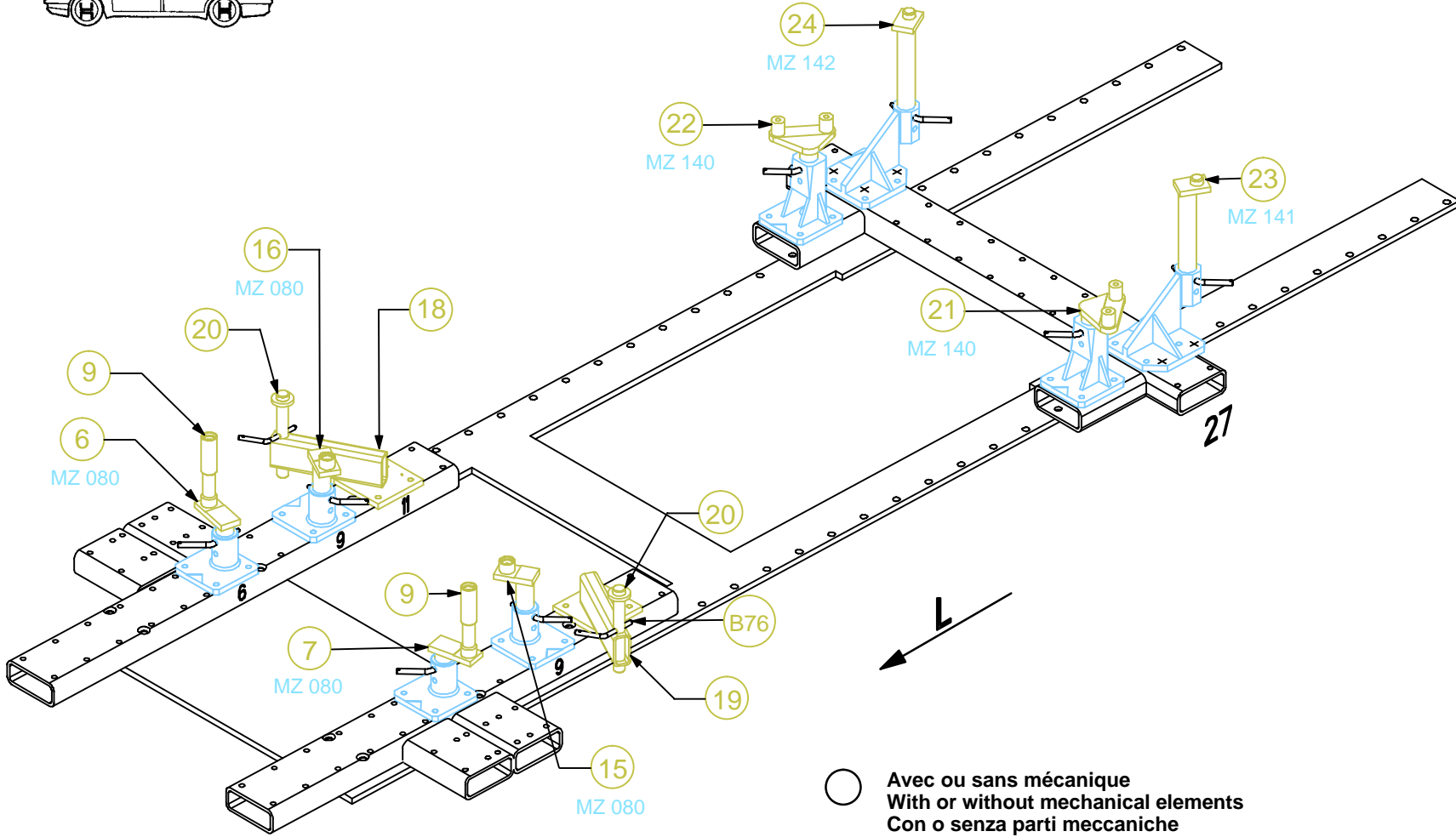
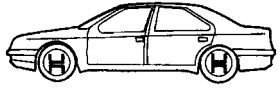

○ Avec ou sans mécanique  
 With or without mechanical elements  
 Con o senza parti meccaniche  
 Mit oder ohne Aggregate  
 Con ó sin mecanica desmontada

**VAS 5195**



**813.300**

78 Kg | 14.03.2000 | 403-D-14B

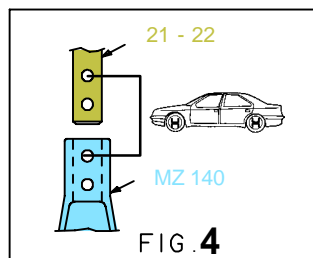
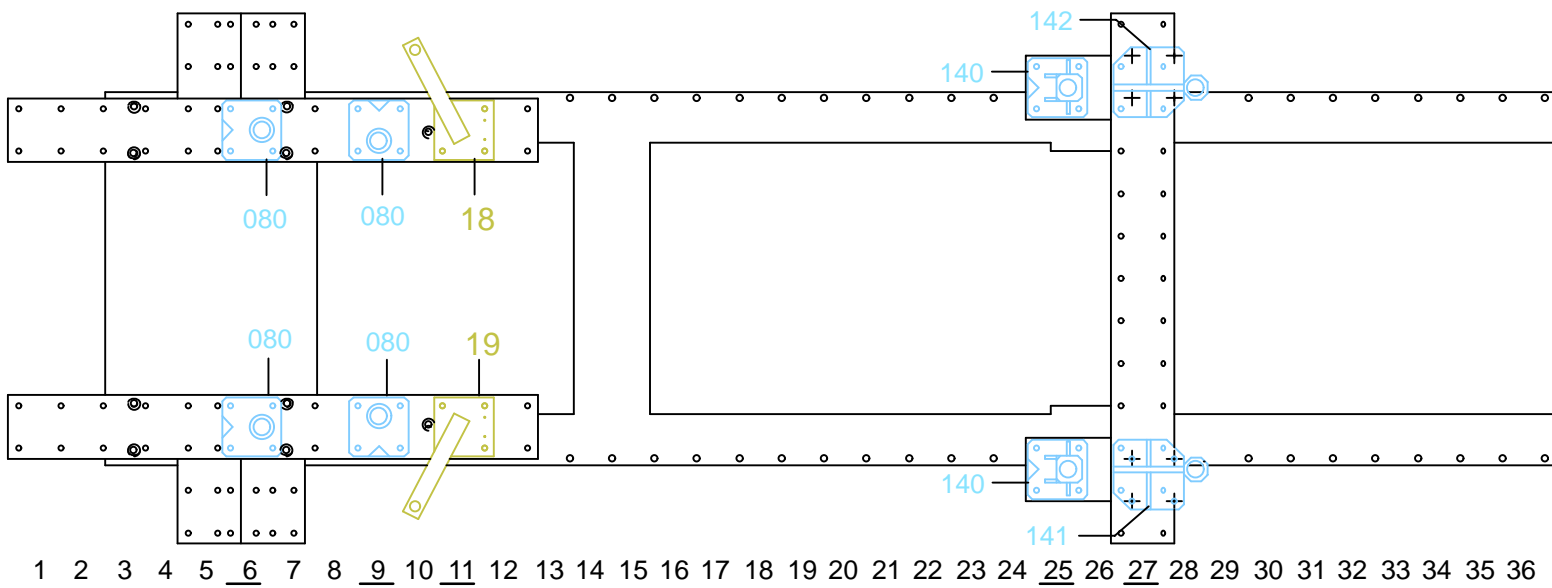

ANCRAGE DU VEHICULE  
 ANCHORING OF THE VEHICLE  
 VERANKERUNG DES FAHRZEUGS  
 ANCORAGGIO DEL VEICOLO  
 ANCLAJE DEL VEHICULO

**MUF 7**

**M8S / MT10**

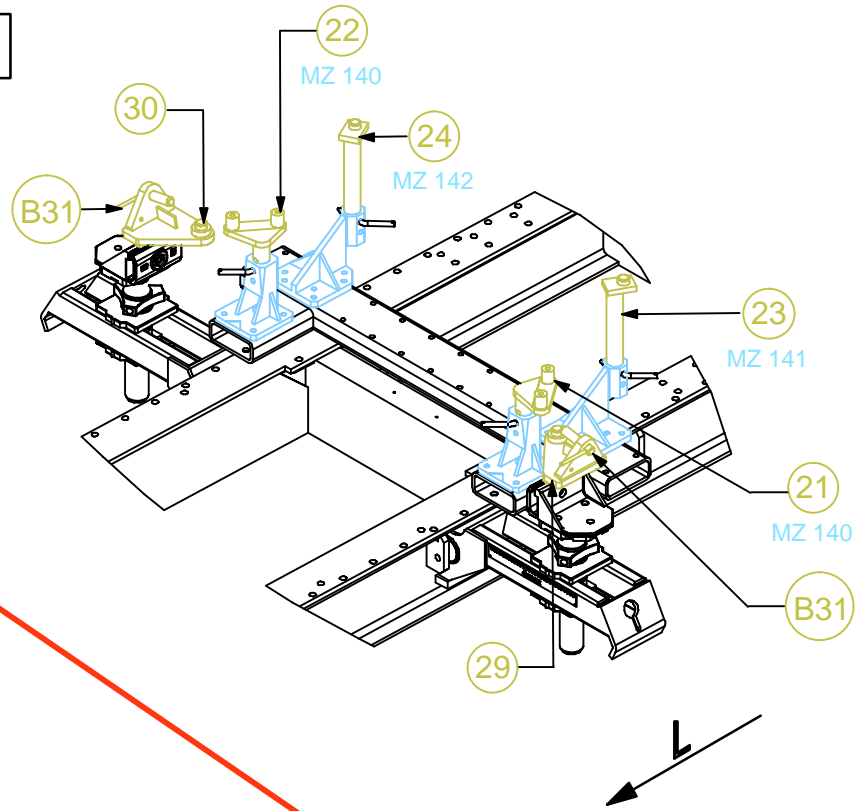
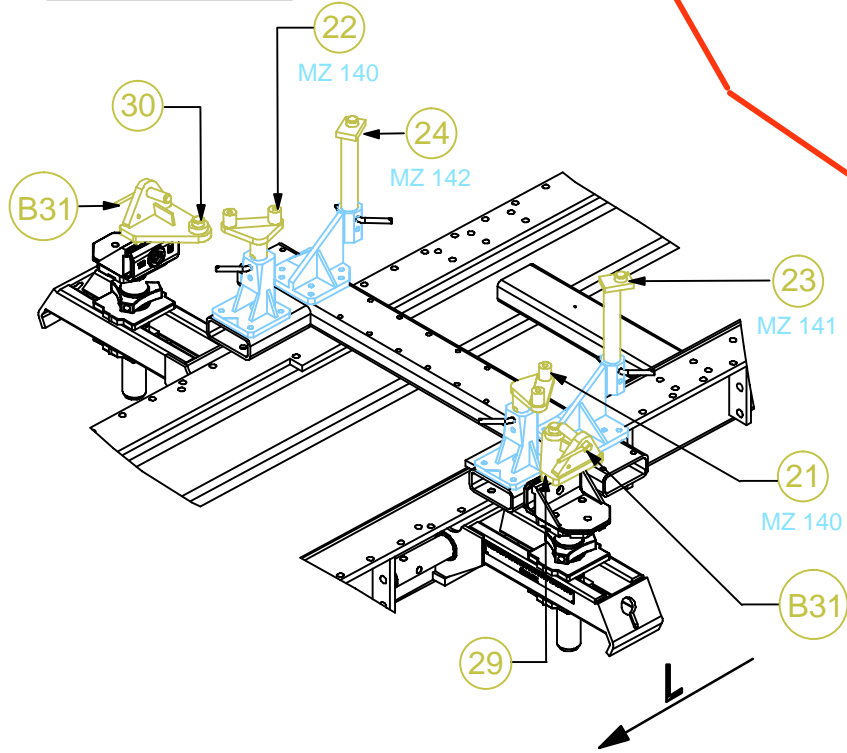

**VAS 5195**

○ Avec ou sans mécanique  
 With or without mechanical elements  
 Con o senza parti meccaniche  
 Mit oder ohne Aggregate  
 Con ó sin mecánica desmontada



**813.300**

78 Kg | 14.03.2000 | 403-D-14C

**SEVENNE**

