

○ Avec ou sans mécanique
With or without mechanical elements
Con o senza parti meccaniche
Mit oder ohne Aggregate
Con ó sin mecanica desmontada

NISSAN

REP.	REFERENCE	PDS	NB	MZ
1	757.7001	1,4	1	141
2	757.7002	1,4	1	142
3	757.7003	1,4	1	140
4	757.7004	1,4	1	140
5	757.7005	0,3	4	
6	757.7006	1,0	4	
7	757.7007	2,4	1	601
8	757.7008	2,4	1	602
9	757.7009	0,8	2	
10	757.7010	1,9	1	080
11	757.7011	1,9	1	080
12	757.7012	0,4	2	
13	757.7013	1,6	1	080
14	757.7014	1,6	1	080
15	757.7015	2,1	1	080
16	757.7016	2,1	1	080
17	757.7017	1,3	1	080
18	757.7018	1,3	1	080
19	757.7019	0,8	2	
20	757.7020	0,2	2	
21	757.7021	2,4	1	200
22	757.7022	2,4	1	200
23	757.7023	3,3	1	260
24	757.7024	3,3	1	260
25	757.7025	2,6	1	200
26	757.7026	2,6	1	200
27	757.7027	2,4	1	601
28	757.7028	2,4	1	602
29	757.7029	3,3	1	260
30	757.7030	3,3	1	260
	CD.30	2,8	8	
	D.078	0,5	2	
	T.042	0,04	2	
	T.037	0,04	2	

	M 6x25	2
	M 10.125x16	2
	M 10.125x30	2
	M 12x25	32
	M 12x30	4
	M 12.125x16	2
	M 14.150x20	4
	CHc 12x25 TB	32
	M 10	2
	M 12	2
	L 10	2
	M 12	2
	M 14	4

757.300

87 Kg 20.06.97 410-D-58A

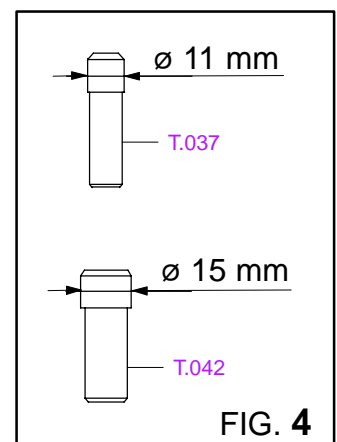
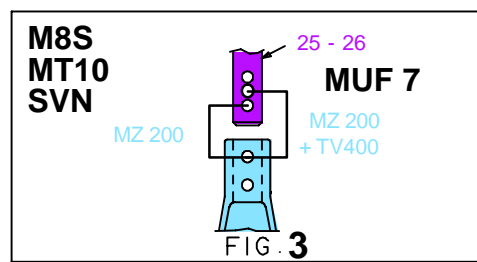
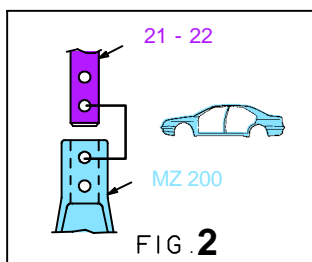
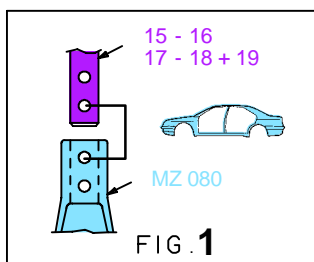
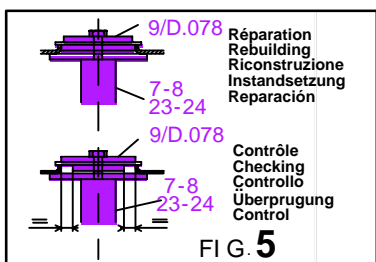
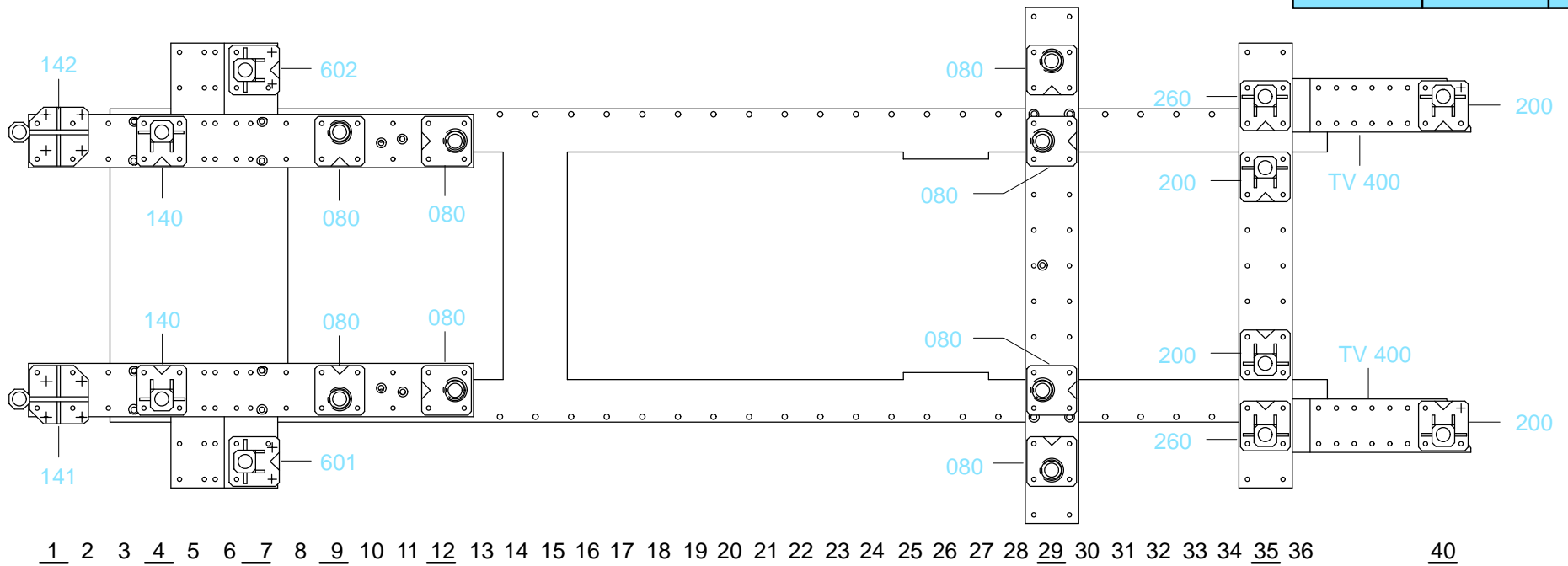

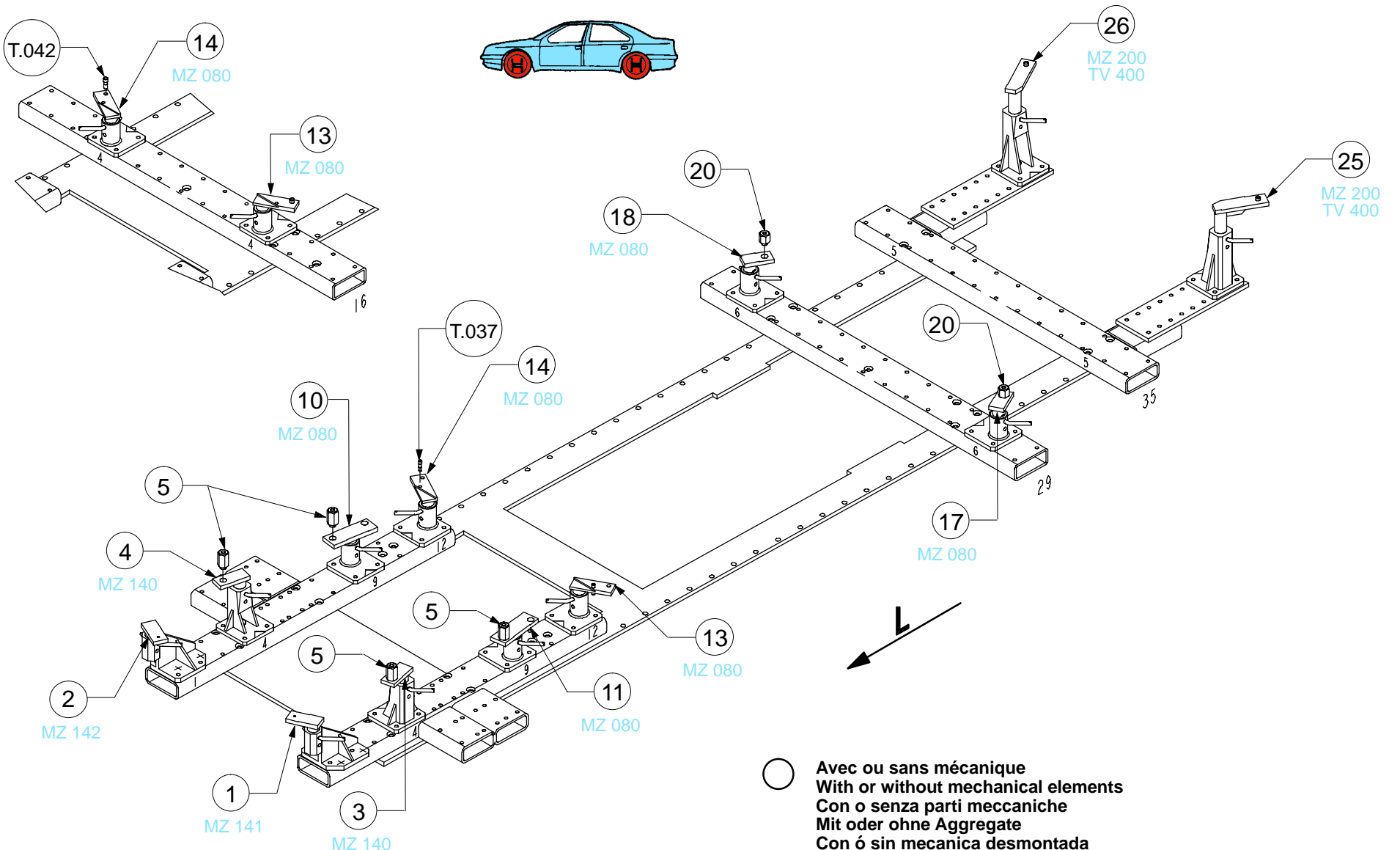

NISSAN

757.300

87 Kg | 20.06.97 | 410-D-58B

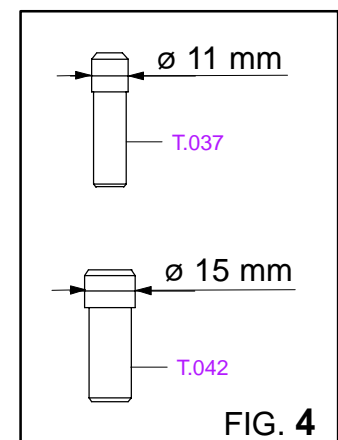
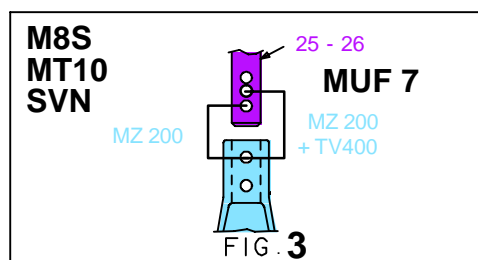
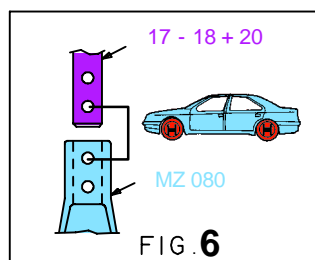
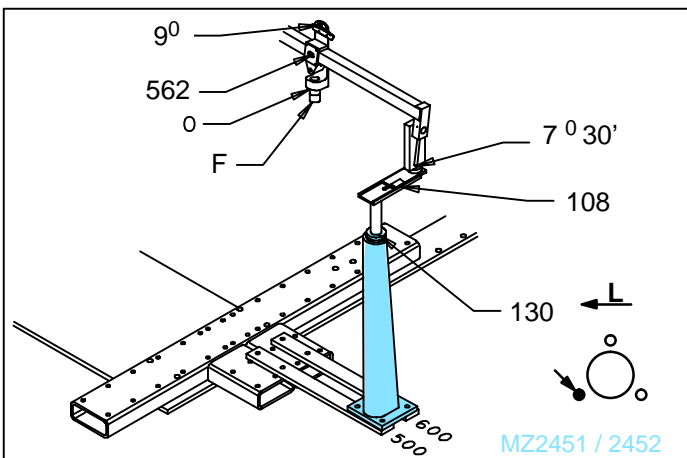
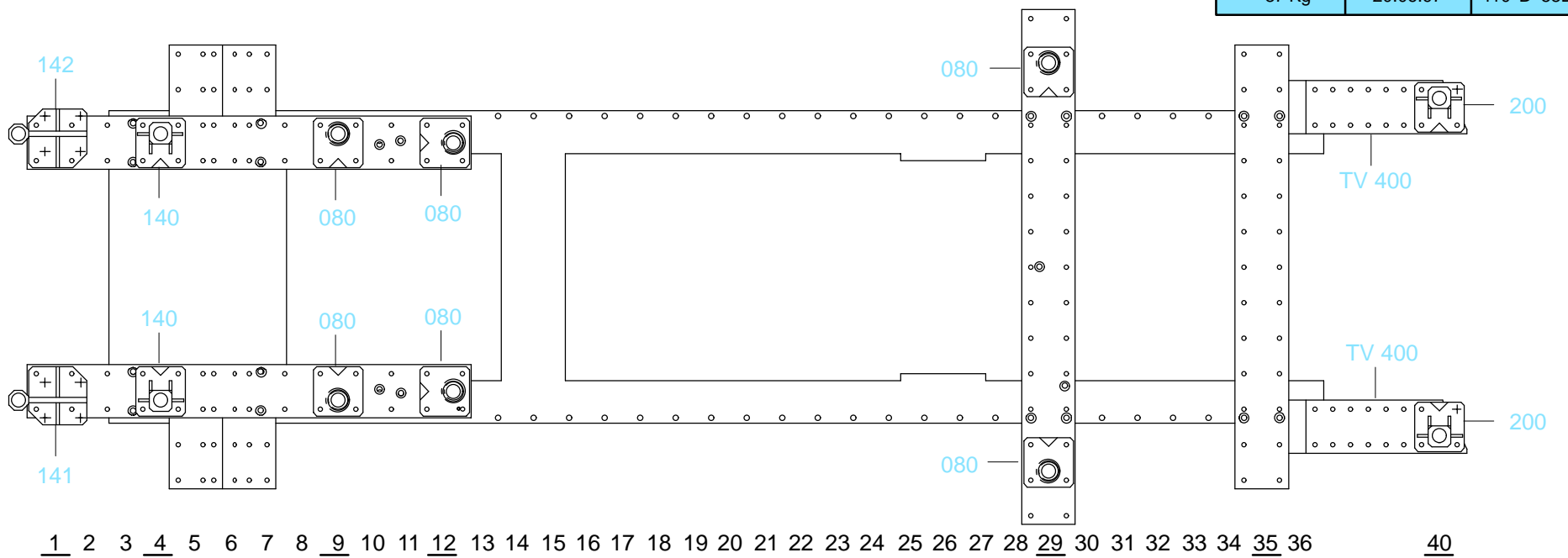

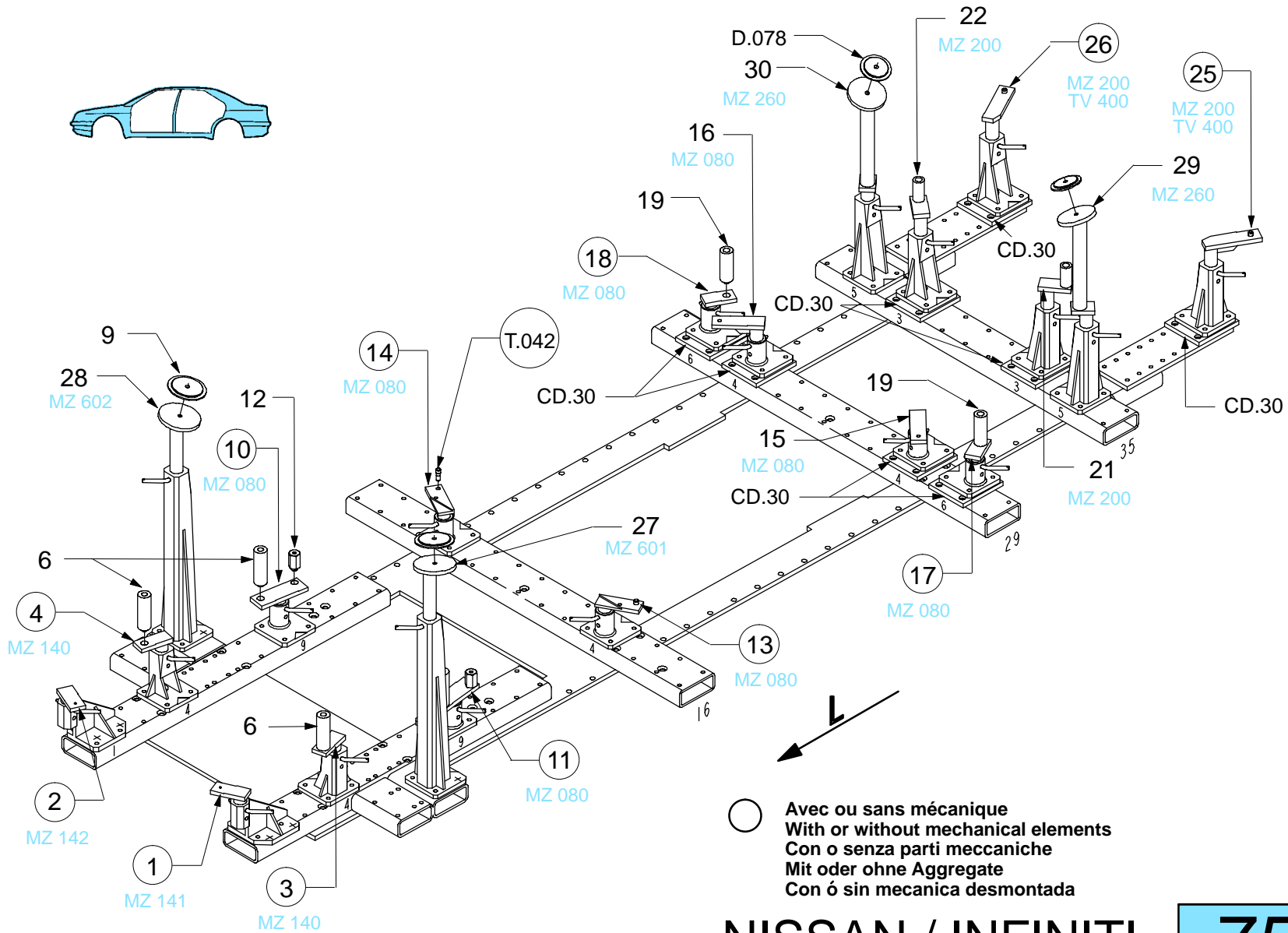

NISSAN / INFINITI

757.300

87 Kg 20.06.97 410-D-58C

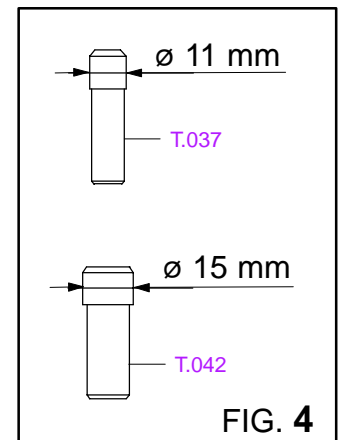
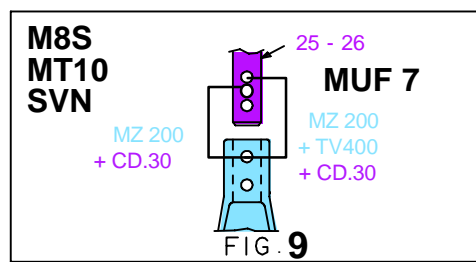
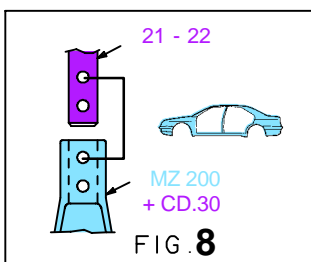
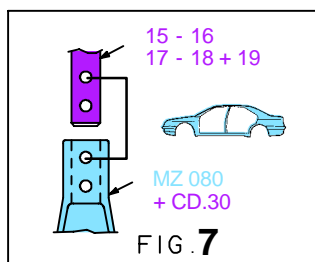
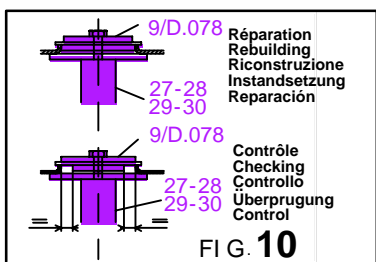
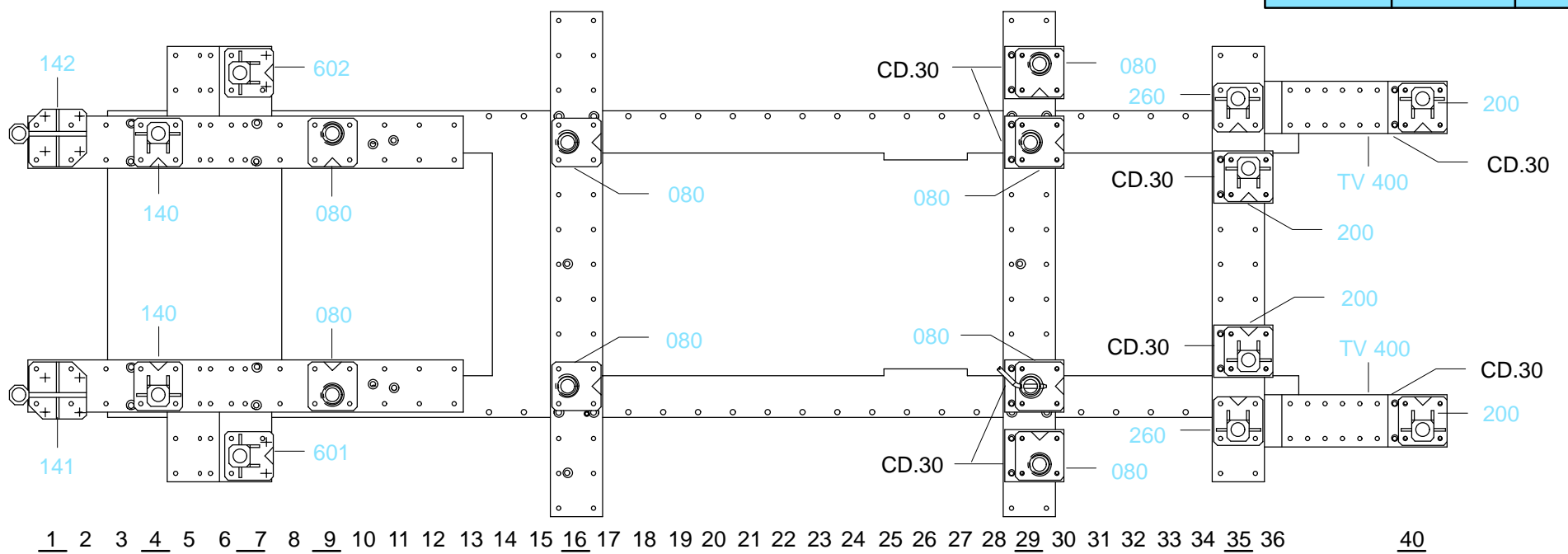

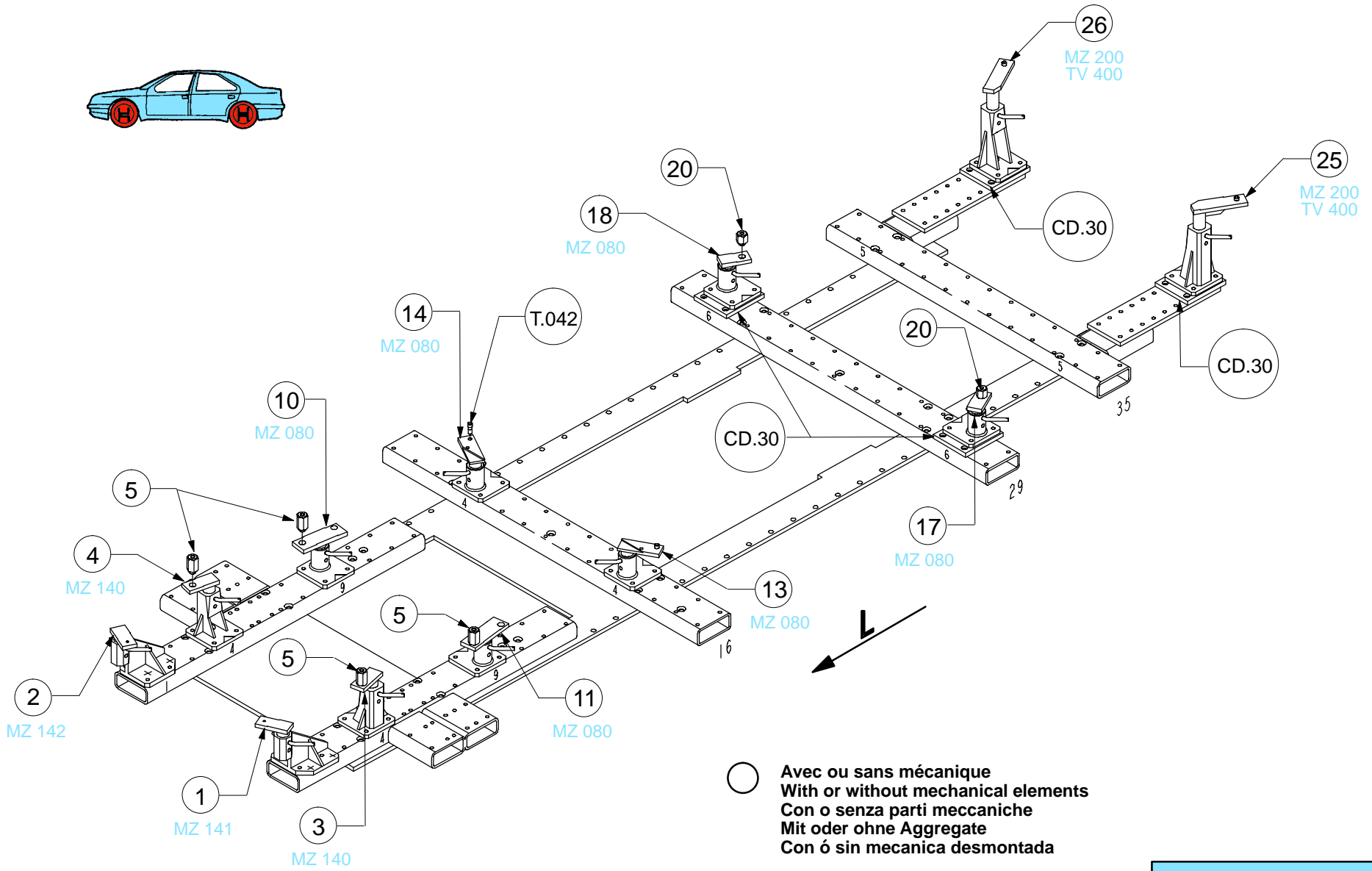
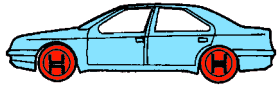

○ Avec ou sans mécanique
With or without mechanical elements
Con o senza parti meccaniche
Mit oder ohne Aggregate
Con ó sin mecánica desmontada

NISSAN / INFINITI

757.300

87 Kg | 20.06.97 | 410-D-58D

