

REP.	MOD.
28 - 29	SEAT IBIZA
31 - 32	POLO CLASSIC / POLO FLIGHT POLO VARIANT / SEAT CORDOBA

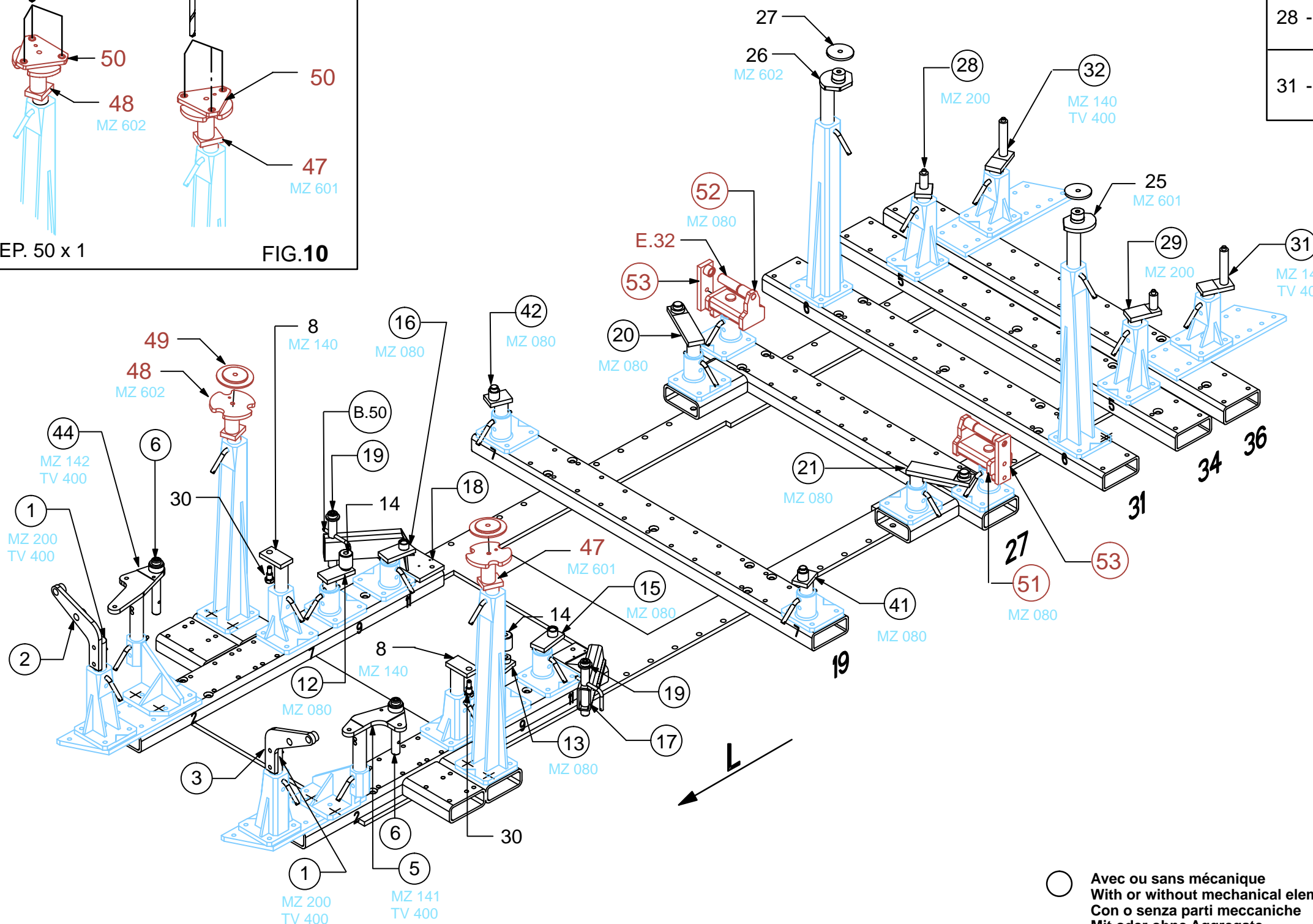

REP.	REFERENCE	PDS	NB	MZ
47	667.747	2,9	1	601
48	667.748	2,4	1	602
49	667.749	0,5	2	
50	667.750	1,3	1	
51	667.751	3,8	1	080
52	667.752	3,8	1	080
53	667.753	0,9	2	
54	667.754	0,05	2	
	E.32	0,1	2	

	M 8-35	1
	M 12-25	4
	M 12-35	2

**IBIZA / CORDOBA**  
 complément au  
 complementary set to  
 complemento al  
 zusatz zu **667.310 + 667.306**

**POLO CLASSIC / POLO FLIGHT**  
**667.310 + 667.307 + 667.306**  
 complément au  
 complementary set to  
 complemento al  
 zusatz zu **727.300 + 667.306**  
 Ou/Or/Oder/O

**727.309**

21 Kg	31.03.2000	438-D-14E
-------	------------	-----------

○ Avec ou sans mécanique  
 With or without mechanical elements  
 Con o senza parti meccaniche  
 Mit oder ohne Aggregate  
 Con ó sin mecanica desmontada

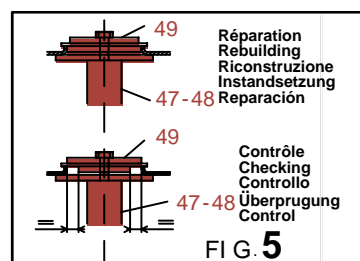
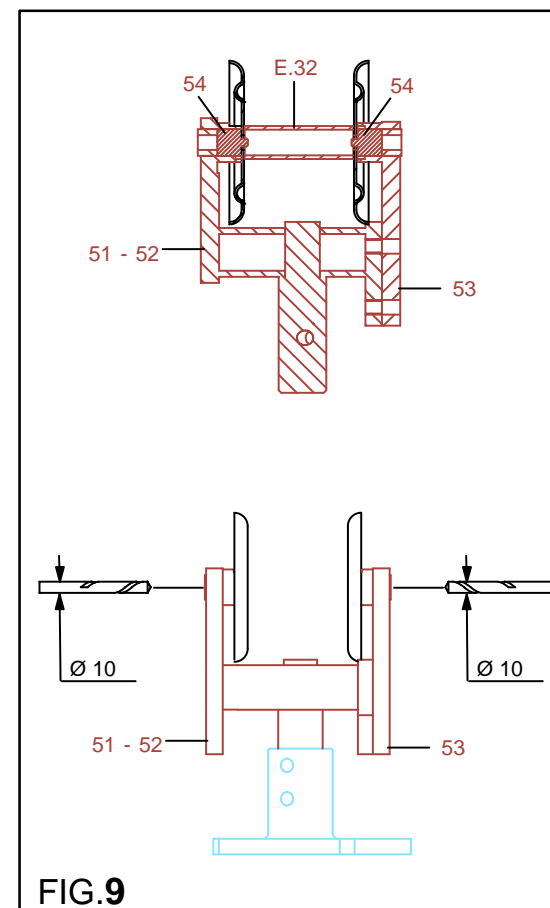
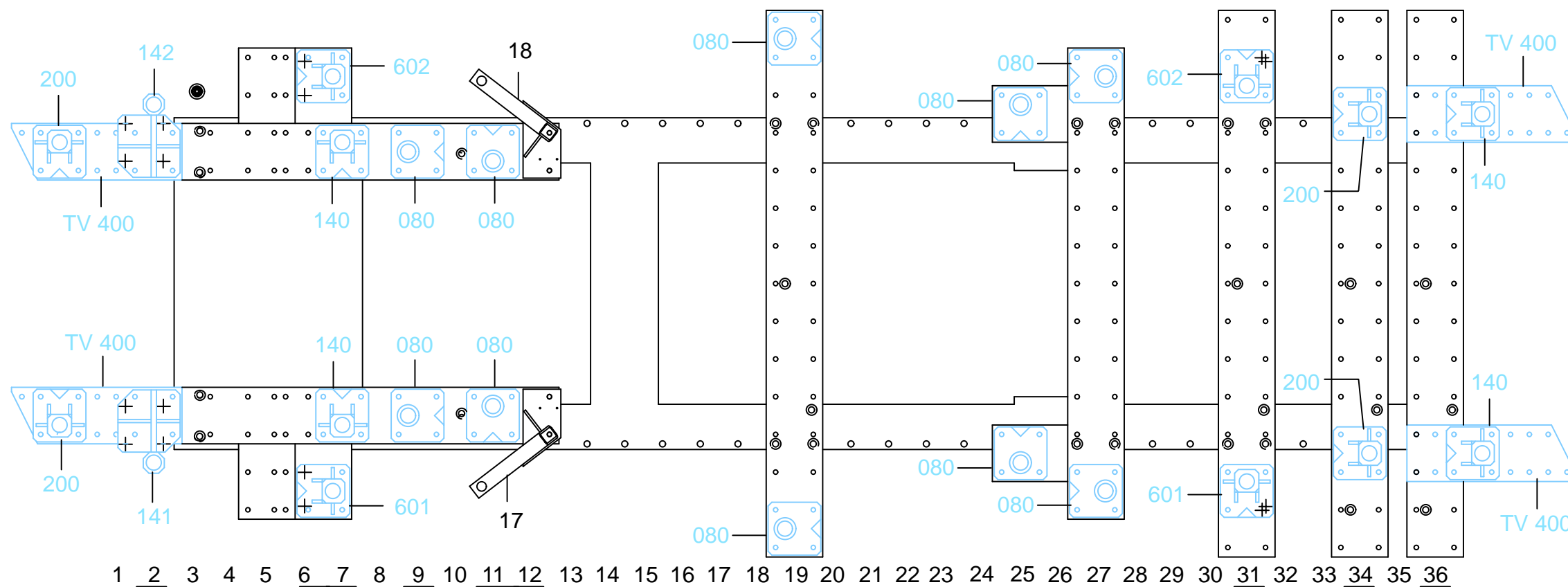
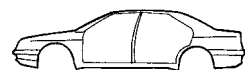

Réparation  
Rebuilding  
Riconstruzione  
Instandsetzung  
Reparación

Contrôle  
Checking  
Controllo  
Überprüfung  
Control

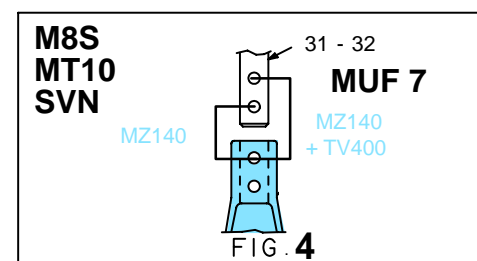
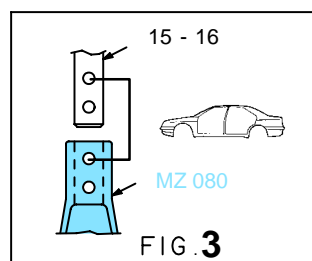
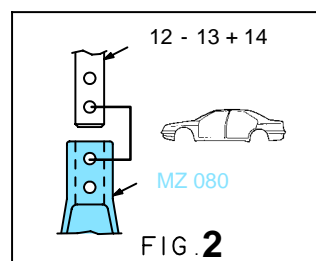
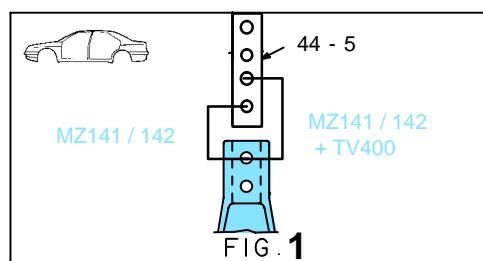

○ Avec ou sans mécanique  
With or without mechanical elements  
Con o senza parti meccaniche  
Mit oder ohne Aggregate  
Con ó sin mecanica desmontada

**VAS 5001/2**



**727.309**

21 Kg	11.02.2000	438-D-14G
-------	------------	-----------

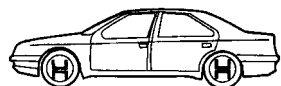

REP.	MOD.
28 - 29	SEAT IBIZA
31 - 32	POLO CLASSIC / POLO FLIGHT POLO VARIANT / SEAT CORDOBA

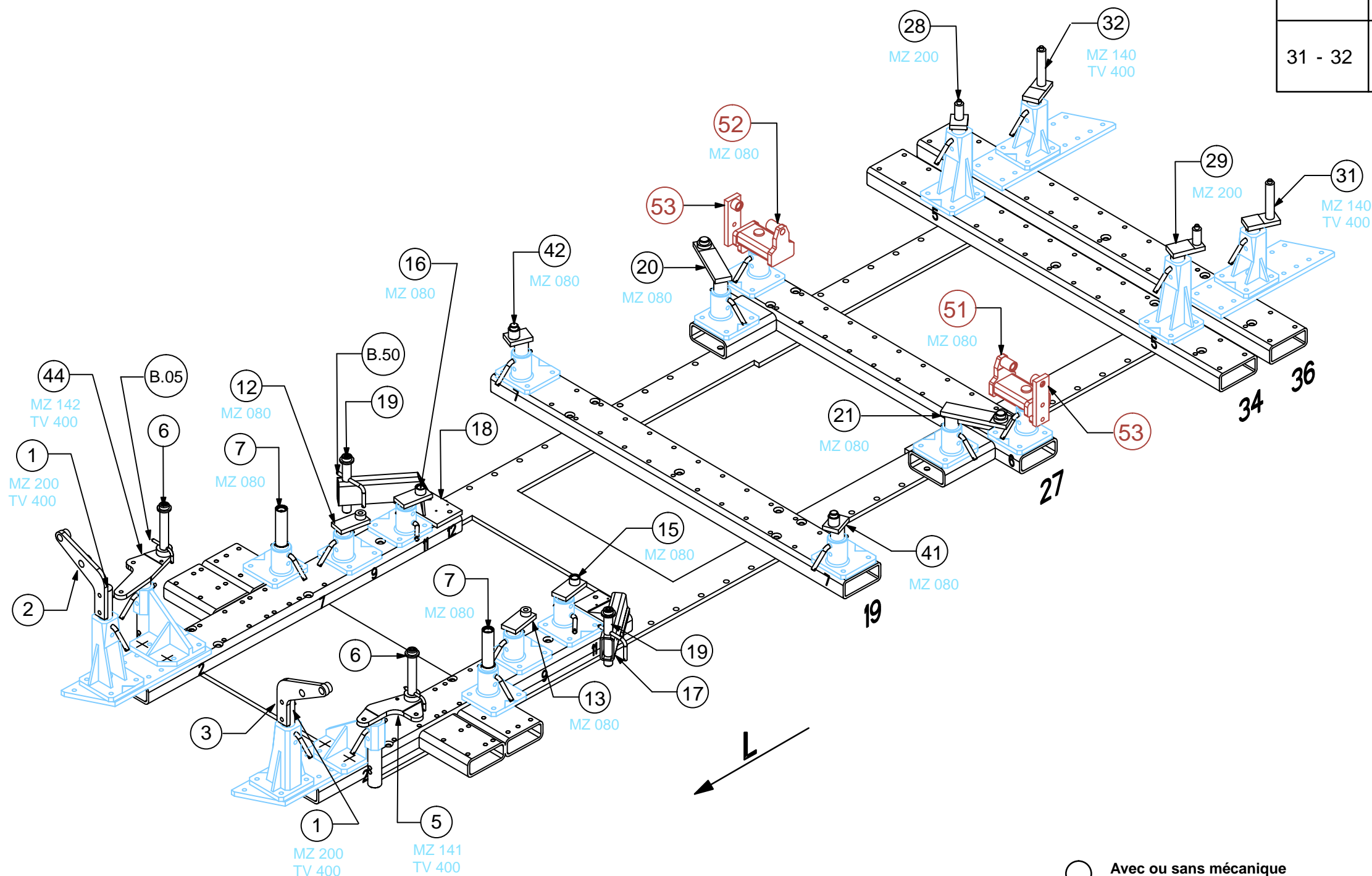

○ Avec ou sans mécanique  
With or without mechanical elements  
Con o senza parti meccaniche  
Mit oder ohne Aggregate  
Con ó sin mecanica desmontada

**VAS 5001/2**



**727.309**

21 Kg	31.03.2000	438-D-14F
-------	------------	-----------

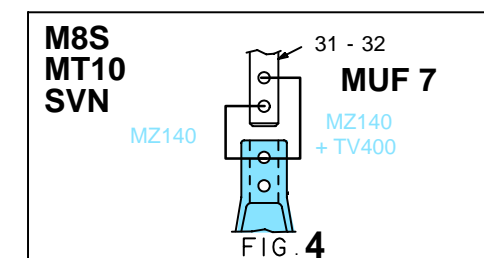
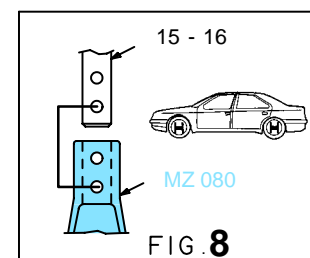
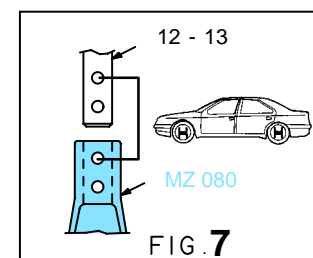
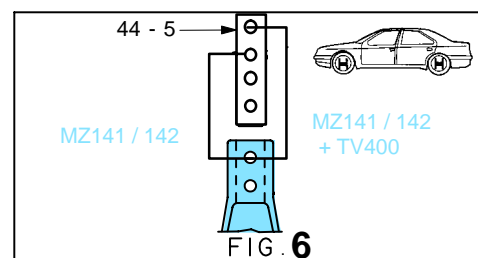
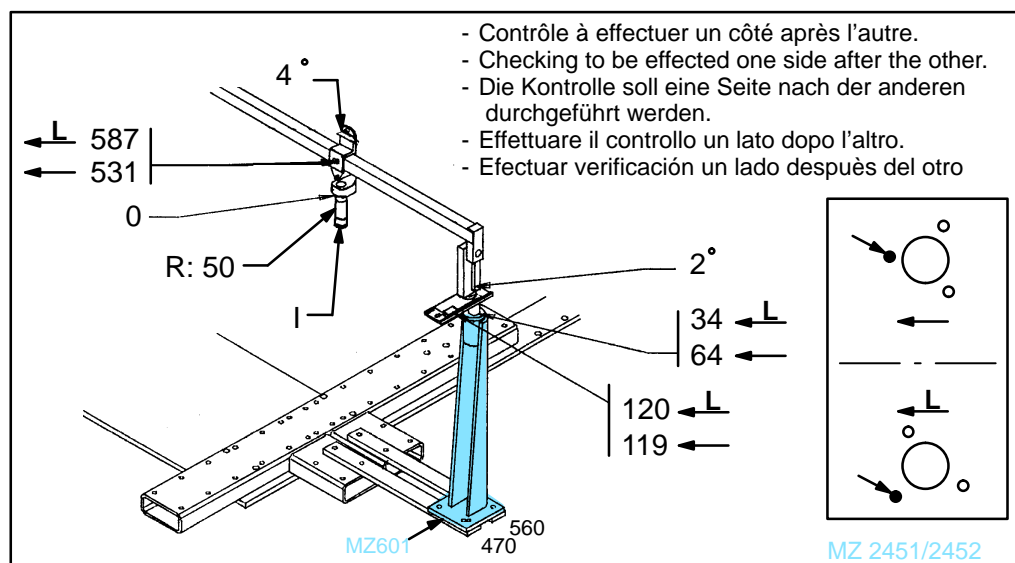
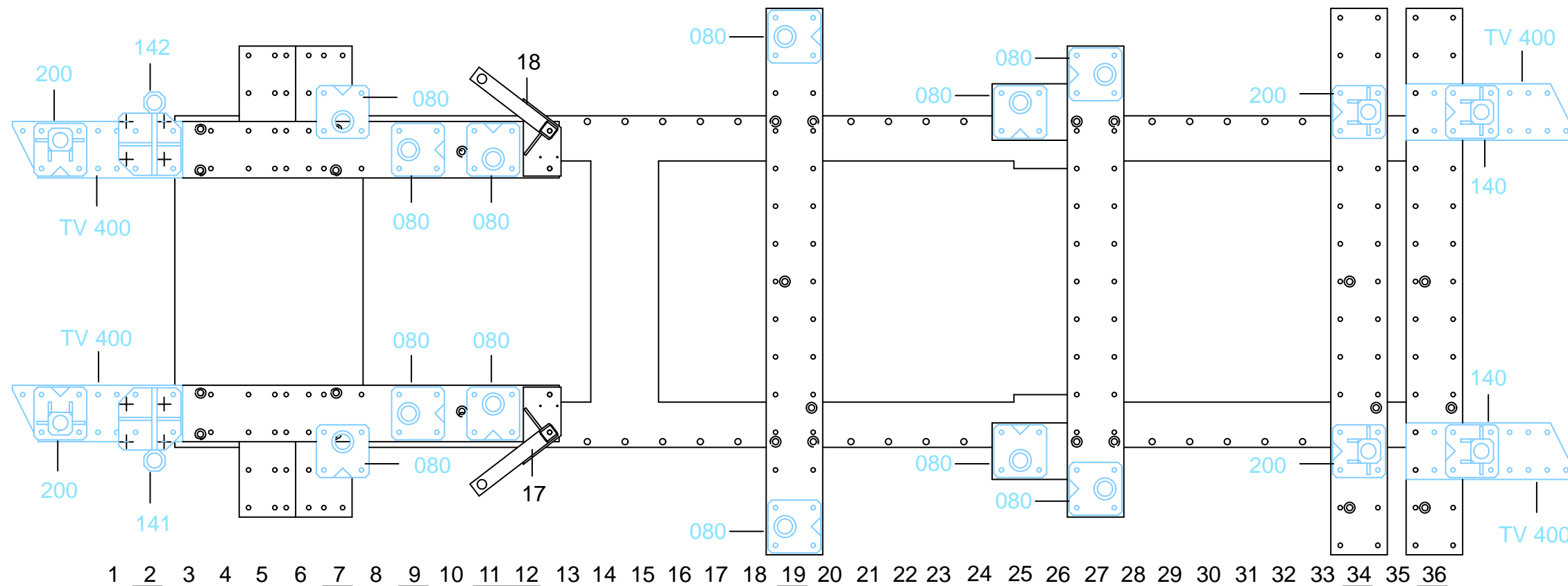

○ Avec ou sans mécanique  
 With or without mechanical elements  
 Con o senza parti meccaniche  
 Mit oder ohne Aggregate  
 Con ó sin mecanica desmontada

**VAS 5001/2**



**727.309**

21 Kg	11.02.2000	438-D-14H
-------	------------	-----------