

REP.	MOD.
33 - 34	Direction assistée Servo steering Servo Lenkung Servosterzo dirección asistida
44 - 45	Direction non assistée Standard steering Standard Lenkung Sterzo classico dirección no asistida

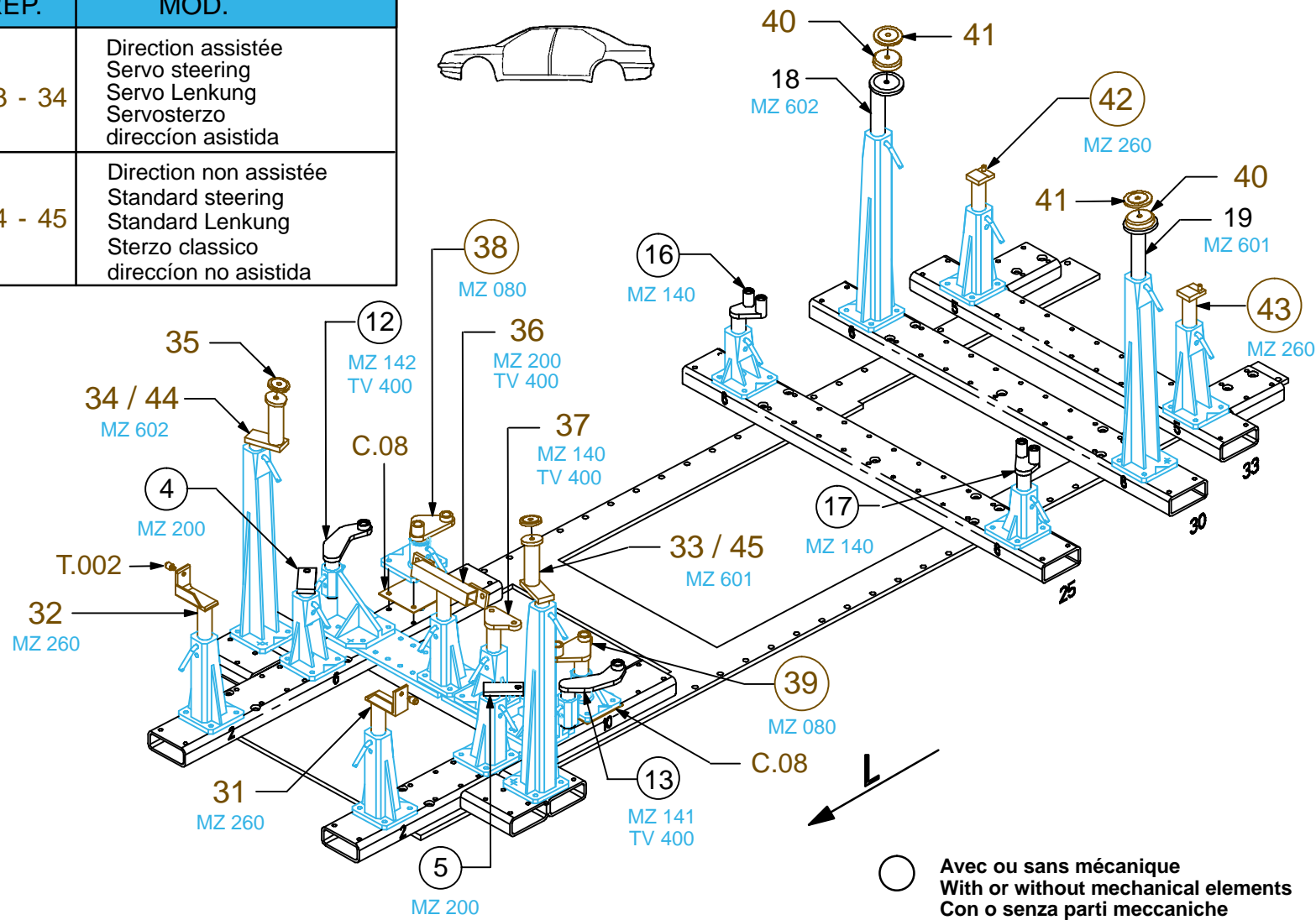

○ Avec ou sans mécanique
With or without mechanical elements
Con o senza parti meccaniche
Mit oder ohne Aggregate
Con ó sin mecanica desmontada

REP.	REFERENCE	PDS	NB	MZ
31	565.731	2,6	1	260
32	565.732	2,6	1	260
33	565.733	1,6	1	601
34	565.734	1,6	1	602
35	565.735	0,2	2	
36	565.736	2,9	1	200
37	565.737	2,3	1	140
38	565.738	2,4	1	080
39	565.739	2,4	1	080
40	565.740	0,5	2	
41	565.741	0,3	2	
42	565.742	2,1	1	260
43	565.743	2,1	1	260
44	565.744	2,1	1	602
45	565.745	2,1	1	601
	C.08	0,3	2	
	T.002	0,1	2	

	M 12x20	4
	M 12x25	2
	M 12x30	2
	M 12x50	2
	M 12x60	2

	MU 12	2
--	-------	---

complément au
complementary set to
complemento al
zusatz zu **565.300**

565.306

30 Kg 02.06.2003 412-D-14K

FORD

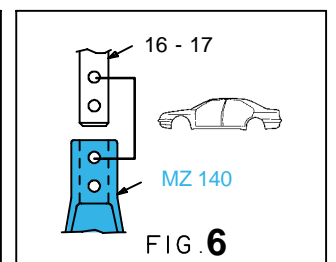
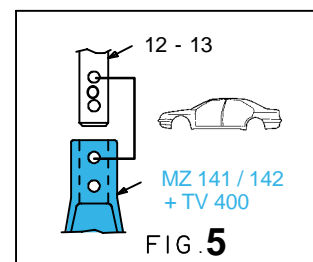
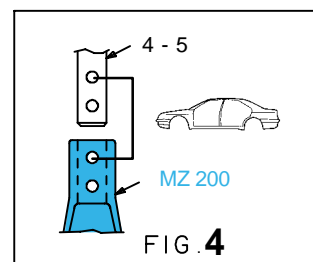
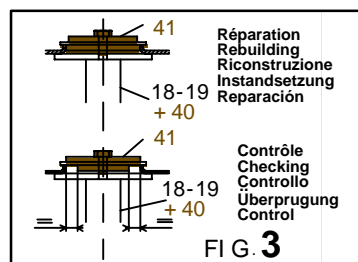
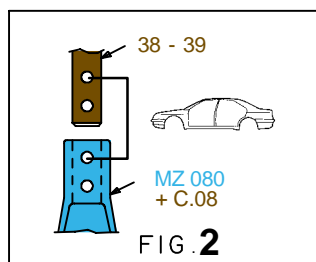
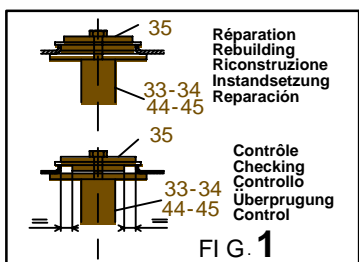
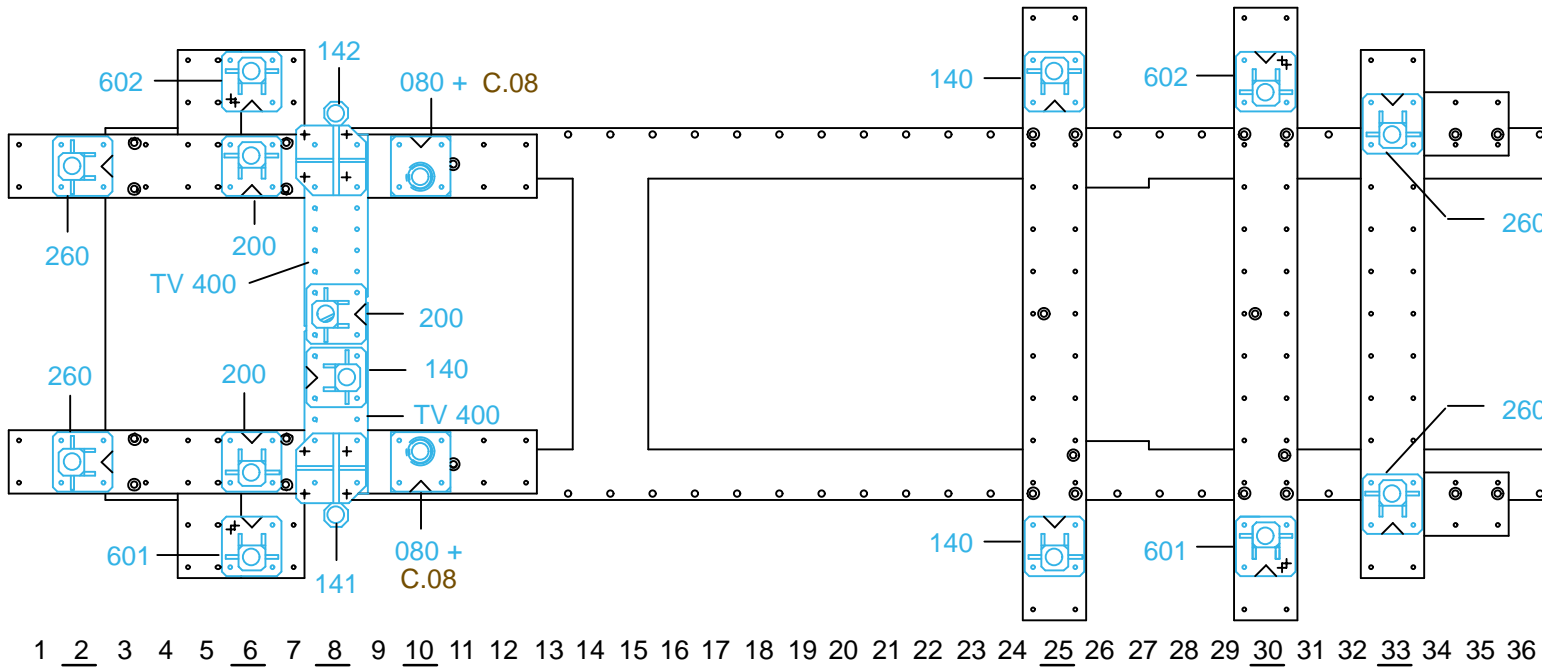

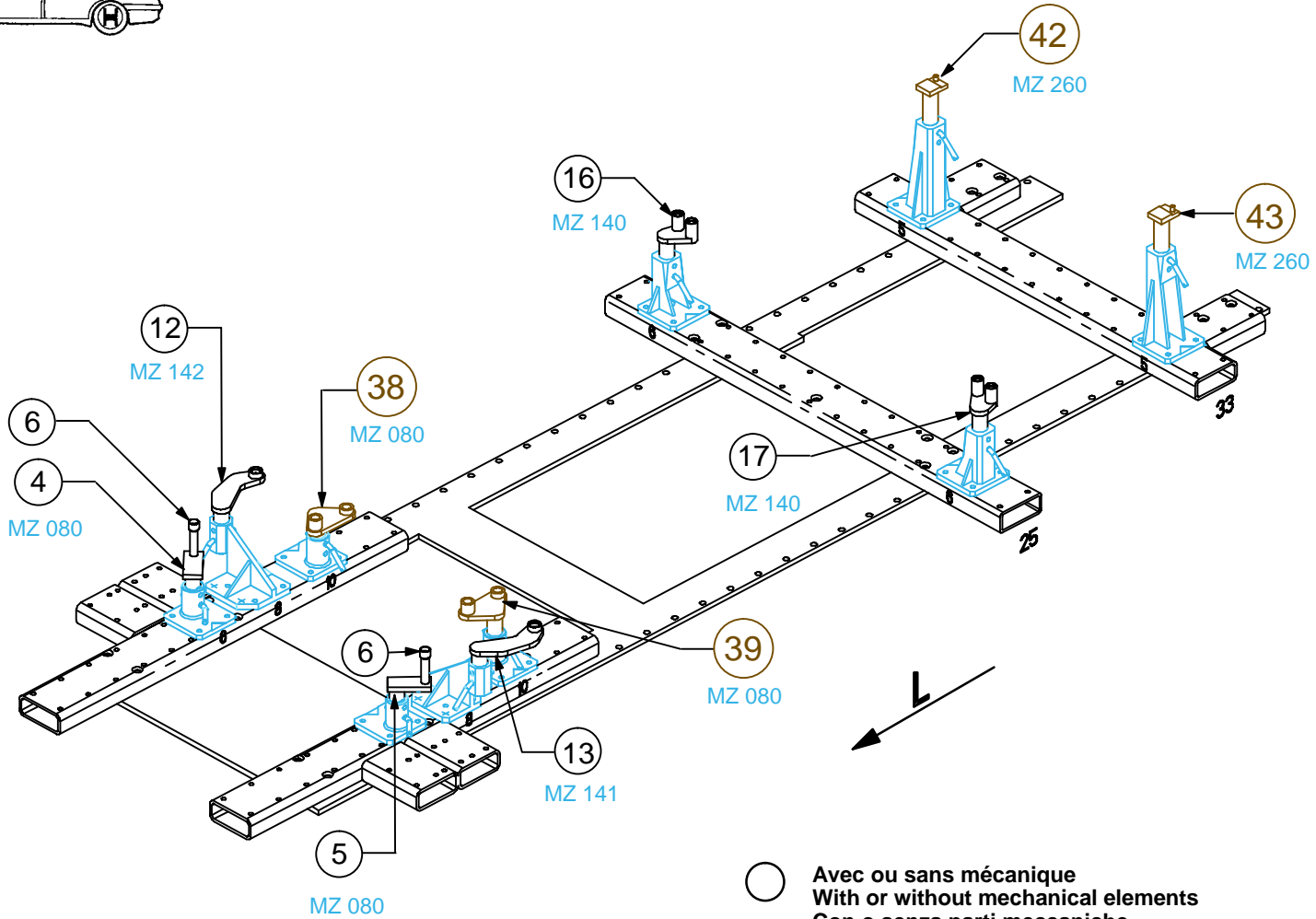

○ Avec ou sans mécanique
 With or without mechanical elements
 Con o senza parti meccaniche
 Mit oder ohne Aggregate
 Con ó sin mecanica desmontada

FORD

565.306

30 Kg | 02.06.2003 | 412-D-14L

