

REP.	REFERENCE	PDS	NB	MZ
1	2060.7001	3,7	1	200
2	2060.7002	3,7	1	200
3	2060.7003	1,2	1	080
4	2060.7004	1,2	1	080
5	2060.7005	2,3	1	080
6	2060.7006	2,3	1	080
7	2060.7007	0,7	2	
8	2060.7008	2,1	1	080
9	2060.7009	3,1	1	141
10	2060.7010	3,1	1	142
11	2060.7011	2,0	1	602
12	2060.7012	2,0	1	601
13	2060.7013	0,9	2	
14	2060.7014	1,8	1	140
15	2060.7015	1,8	1	140
16	2060.7016	6,1	1	
17	2060.7017	6,1	1	
18	2060.7018	0,9	2	
19	2060.7019	2,3	1	080
20	2060.7020	2,3	1	080
21	2060.7021	0,05	2	
22	2060.7022	2,0	1	140
23	2060.7023	2,0	1	140
24	2060.7024	2,3	1	200
25	2060.7025	2,3	1	200
26	2060.7026	2,3	1	080/200
27	2060.7027	2,3	1	080/200
28	2060.7028	0,4	2	
29	2060.7029	4,9	1	260
30	2060.7030	4,9	1	260
31	2060.7031	0,4	2	
32	2060.7032	0,2	2	
33	2060.7033	2,0	1	
34	2060.7034	2,0	1	
35	2060.7035	0,4	2	
36	2060.7036	4,0	1	200
37	2060.7037	4,0	1	200
38	2060.7038	2,6	1	260
39	2060.7039	2,6	1	260
40	2060.7040	1,0	1	
41	2060.7041	1,0	1	
42	2060.7042	3,7	1	200
43	2060.7043	3,7	1	200
44	2060.7044	1,0	1	
	B76	0,1	2	

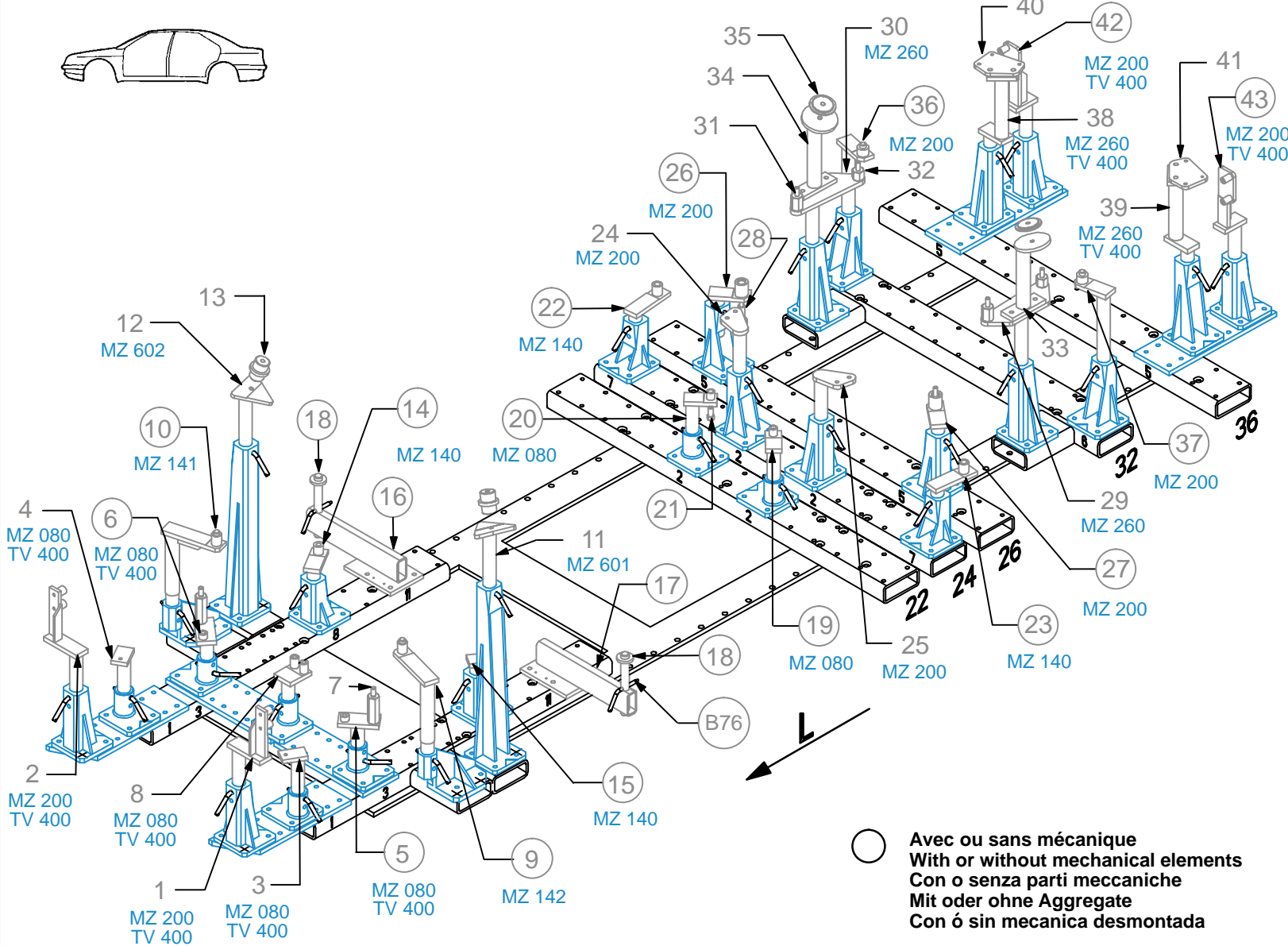

○ Avec ou sans mécanique  
 With or without mechanical elements  
 Con o senza parti meccaniche  
 Mit oder ohne Aggregate  
 Con ó sin mecanica desmontada

M 8-25	4
M 8-30	2
M 8-55	8
M 10-35	4
M 10-80	2
M 12-25	10
M 12-30	4
M 12-90	2
M 12x1,50-50	2
M 12x1,50-60	4
M 14x1,50-70	2
Chc 12-25	2

## PORSCHE

# 2060.300

108 Kg    22.07.2004    425-D-7A

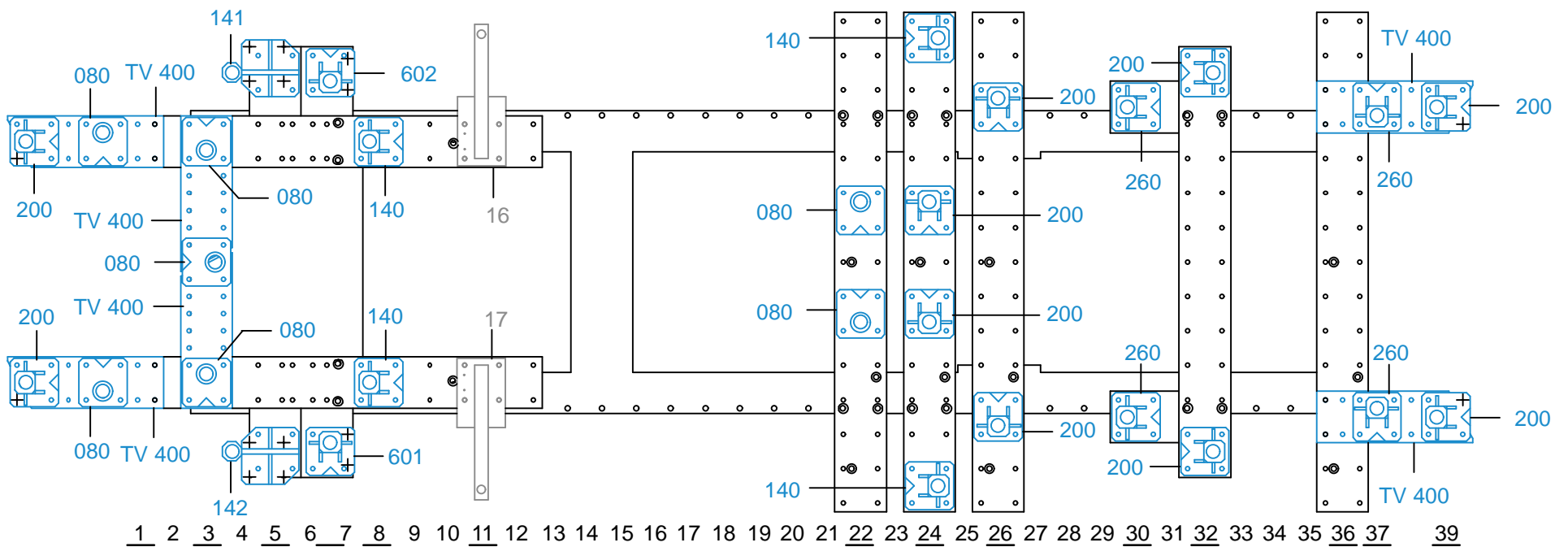

1 2 3 4 5 6 7 8 9 10 11 12 13 14 15 16 17 18 19 20 21 22 23 24 25 26 27 28 29 30 31 32 33 34 35 36 37 39

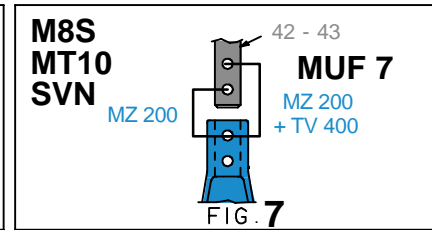
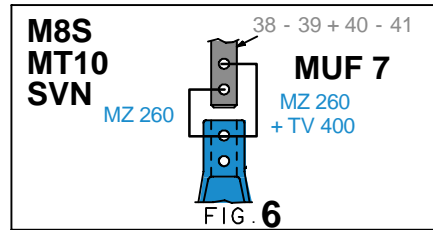
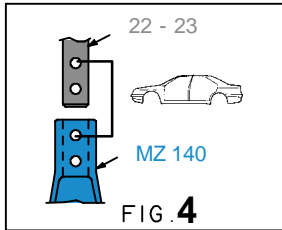
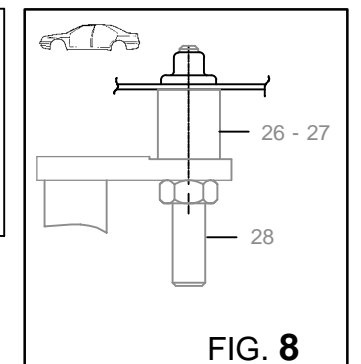
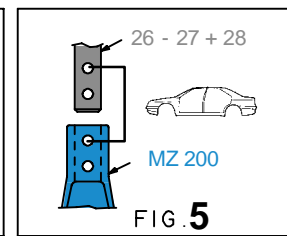
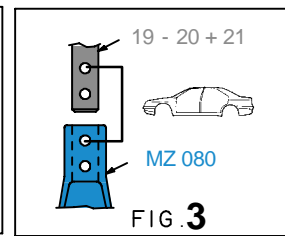
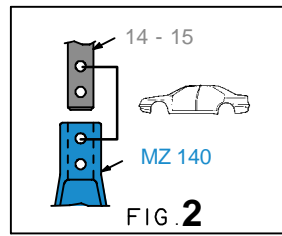
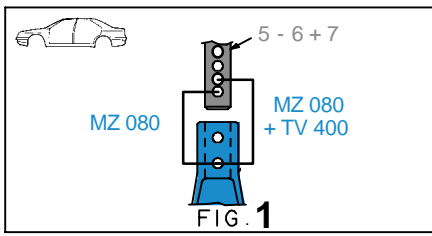
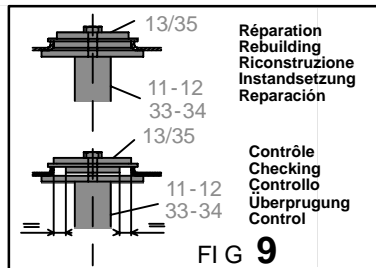

2060.300-RVA3-1 00

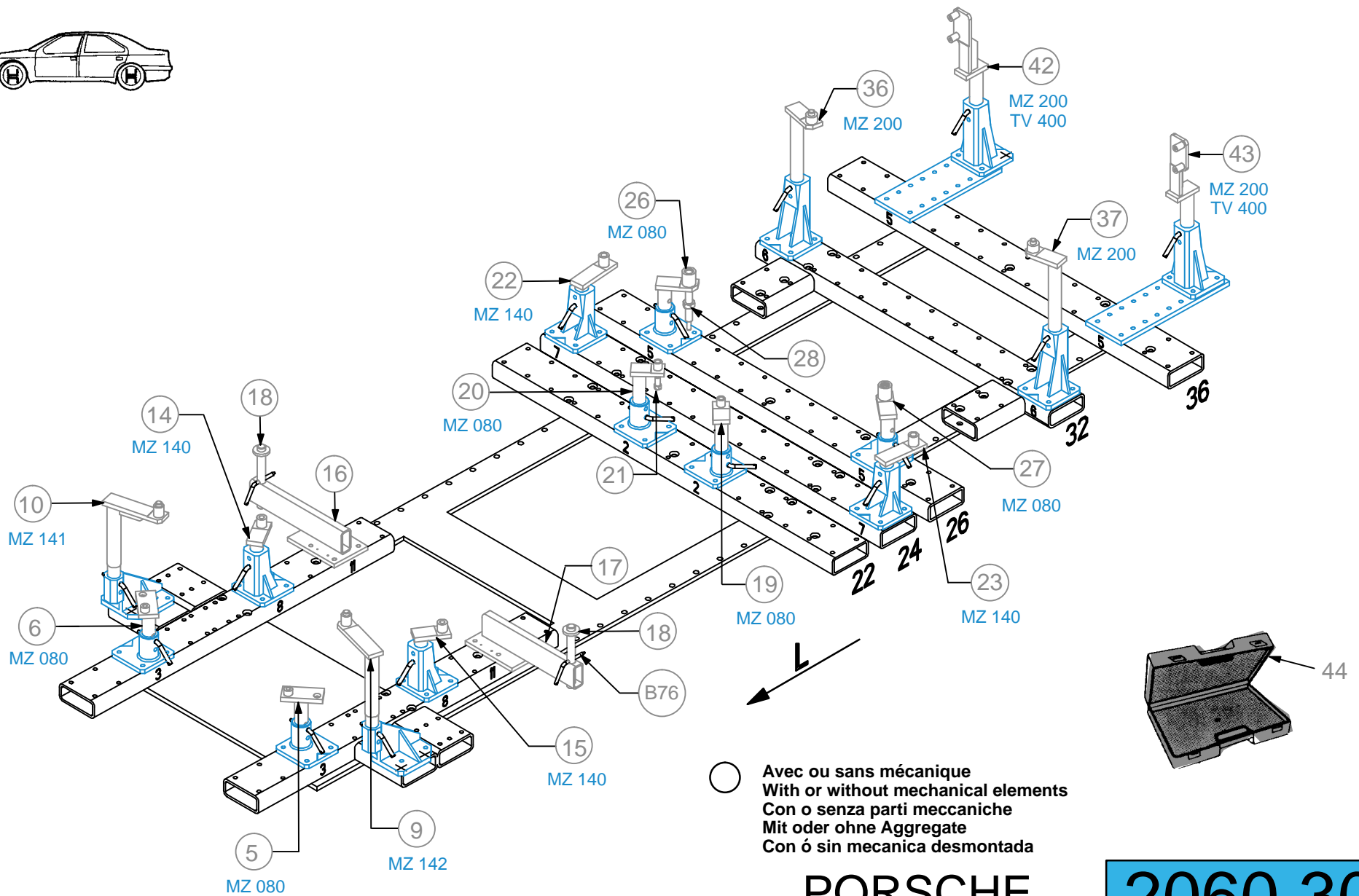
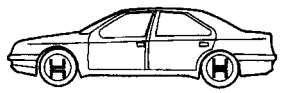

○ Avec ou sans mécanique  
 With or without mechanical elements  
 Con o senza parti meccaniche  
 Mit oder ohne Aggregate  
 Con ó sin mecánica desmontada

**PORSCHE**

**2060.300**

108 Kg	22.07.2004	425-D-7B
--------	------------	----------

