

REP.	REFERENCE	PDS	NB	MZ
1	2048.7001	3,5	1	141
2	2048.7002	3,5	1	142
3	2048.7003	2,0	1	
4	2048.7004	2,0	1	
5	2048.7005	3,2	1	601
6	2048.7006	3,2	1	602
7	2048.7007	0,7	2	
8	2048.7008	1,7	1	260/080
9	2048.7009	1,7	1	260/080
10	2048.7010	0,9	2	
11	2048.7011	1,3	2	
12	2048.7012	1,7	1	140/080
13	2048.7013	1,7	1	140/080
14	2048.7014	4,5	1	
15	2048.7015	4,5	1	
16	2048.7016	0,8	2	
17	2048.7017	2,5	1	080
18	2048.7018	2,5	1	080
19	2048.7019	2,7	1	200/140
20	2048.7020	2,7	1	200/140
21	2048.7021	0,7	2	
22	2048.7022	0,6	2	
23	2048.7023	3,2	1	140
24	2048.7024	3,2	1	140
25	2048.7025	2,0	1	601
26	2048.7026	2,0	1	602
27	2048.7027	0,05	2	
28	2048.7028	2,4	1	260
29	2048.7029	2,4	1	260
30	2048.7030	2,3	1	260
31	2048.7031	2,3	1	260
	V32	0,1	2	
	B76	0,1	2	

M 8-20	6
M 8-25	4
M 12-20	4
M 12-25	2
M 12x1,25-40	6
M 12x1,25-80	2
M 12x1,25-120	2
M 12x1,25-140	2
M 12x1,25-160	2
M 16x1,50-90	2
M 16x1,50-130	2
CHc 8-30	2
MU 12	2

○ Avec ou sans mécanique
With or without mechanical elements
Con o senza parti meccaniche
Mit oder ohne Aggregate
Con ó sin mecanica desmontada

MAZDA

2048.300

76 Kg 20.10.2004 419-D-32A

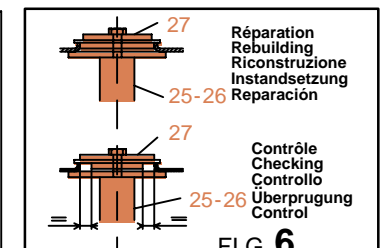
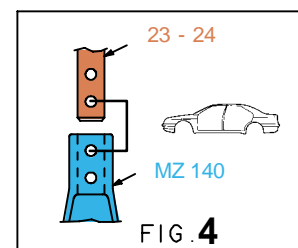
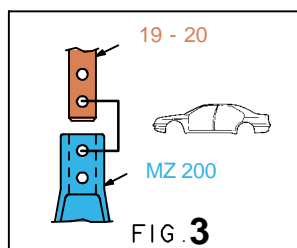
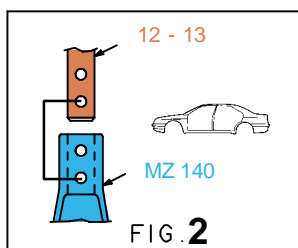
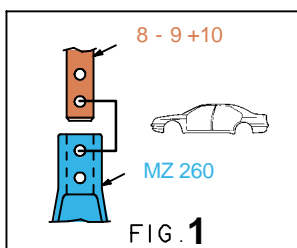
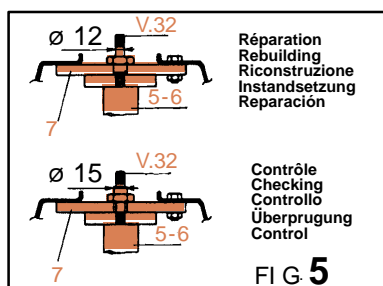
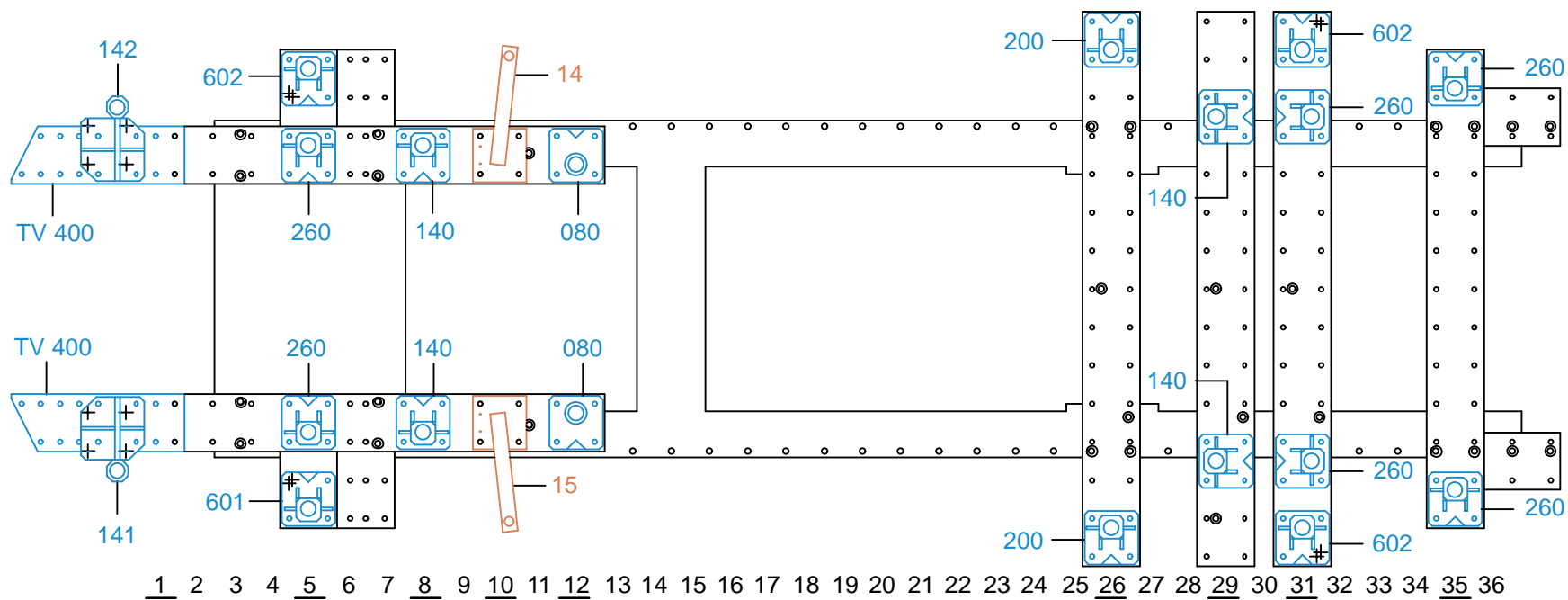

2048.300-RVA3-1 00

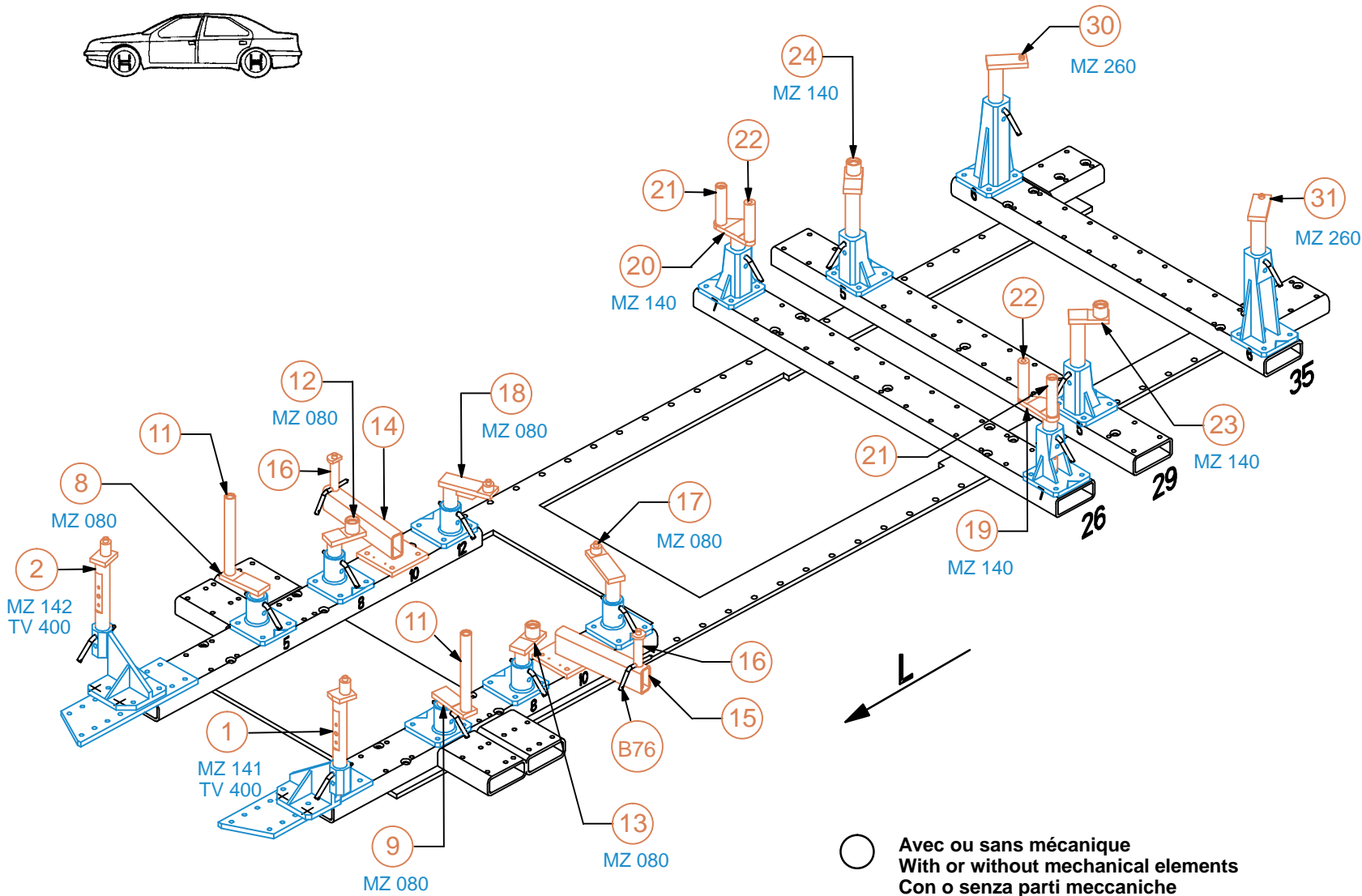
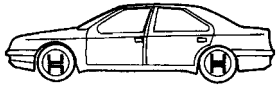

MAZDA

2048.300		
76 Kg	20.10.2004	419-D-32B

