

○ Avec ou sans mécanique
 With or without mechanical elements
 Con o senza parti meccaniche
 Mit oder ohne Aggregate
 Con ó sin mecanica desmontada

NISSAN

REP.	REFERENCE	PDS	NB	MZ
35	2011.7035	2,3	1	200/080
36	2011.7036	2,3	1	200/080
37	2011.7037	1,8	1	601
38	2011.7038	1,8	1	602
39	2011.7039	1,5	1	260
40	2011.7040	1,4	1	260
41	2011.7041	0,3	2	

	M 10x1,25-30	4
	M 12	2

complément au
 complementary set to
 complemento al
 Zusatz zu **2011.310**

2011.308

12 Kg 20.06.2006 410-D-67K

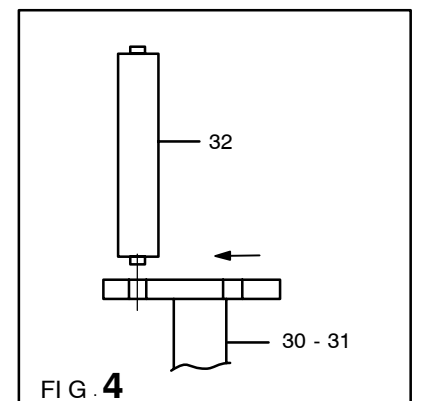
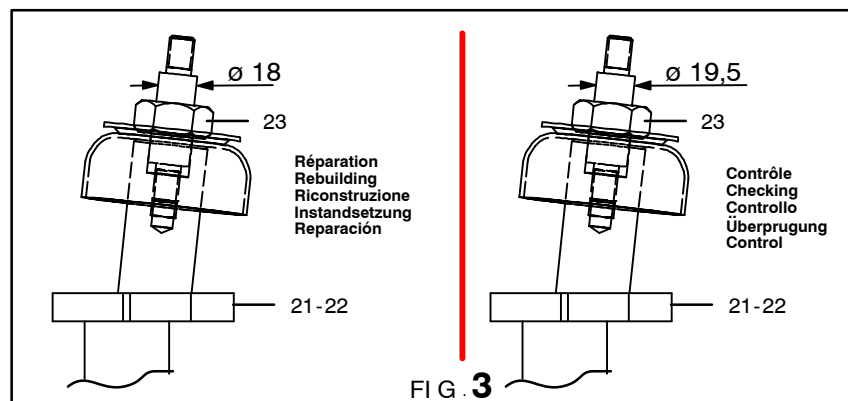
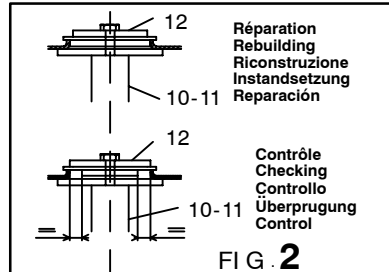
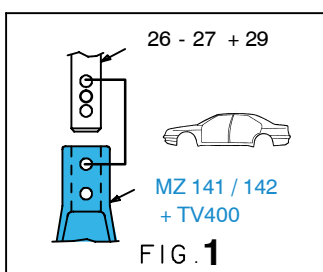
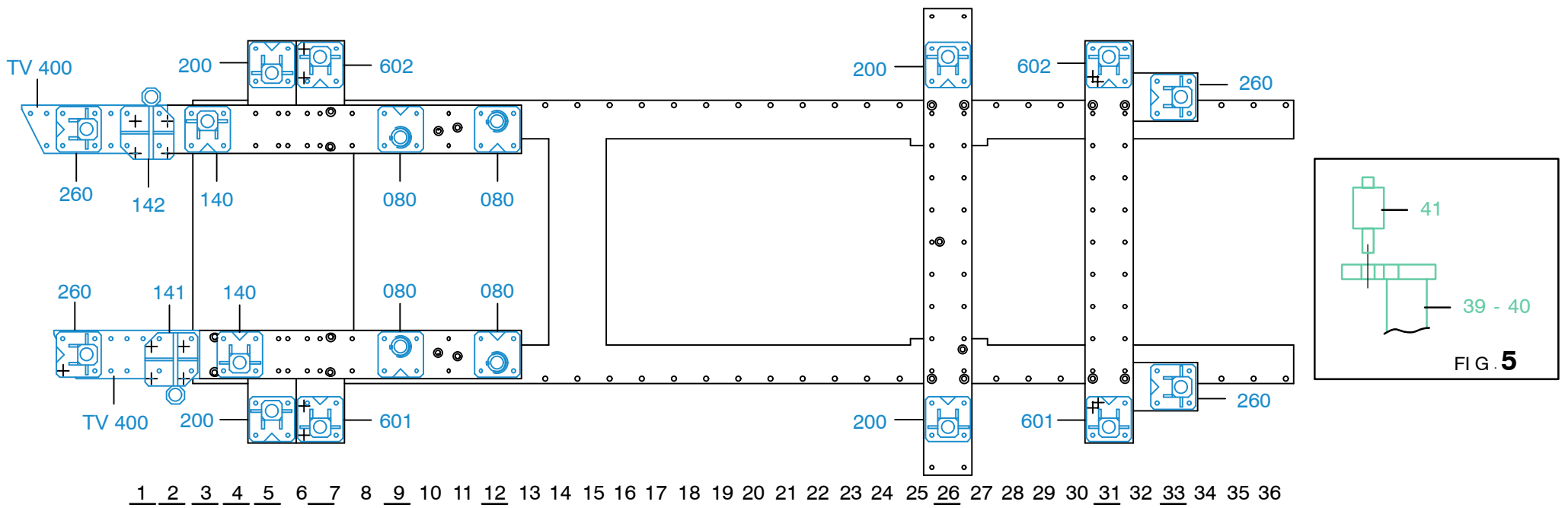

2011.308-RVA3-1 00

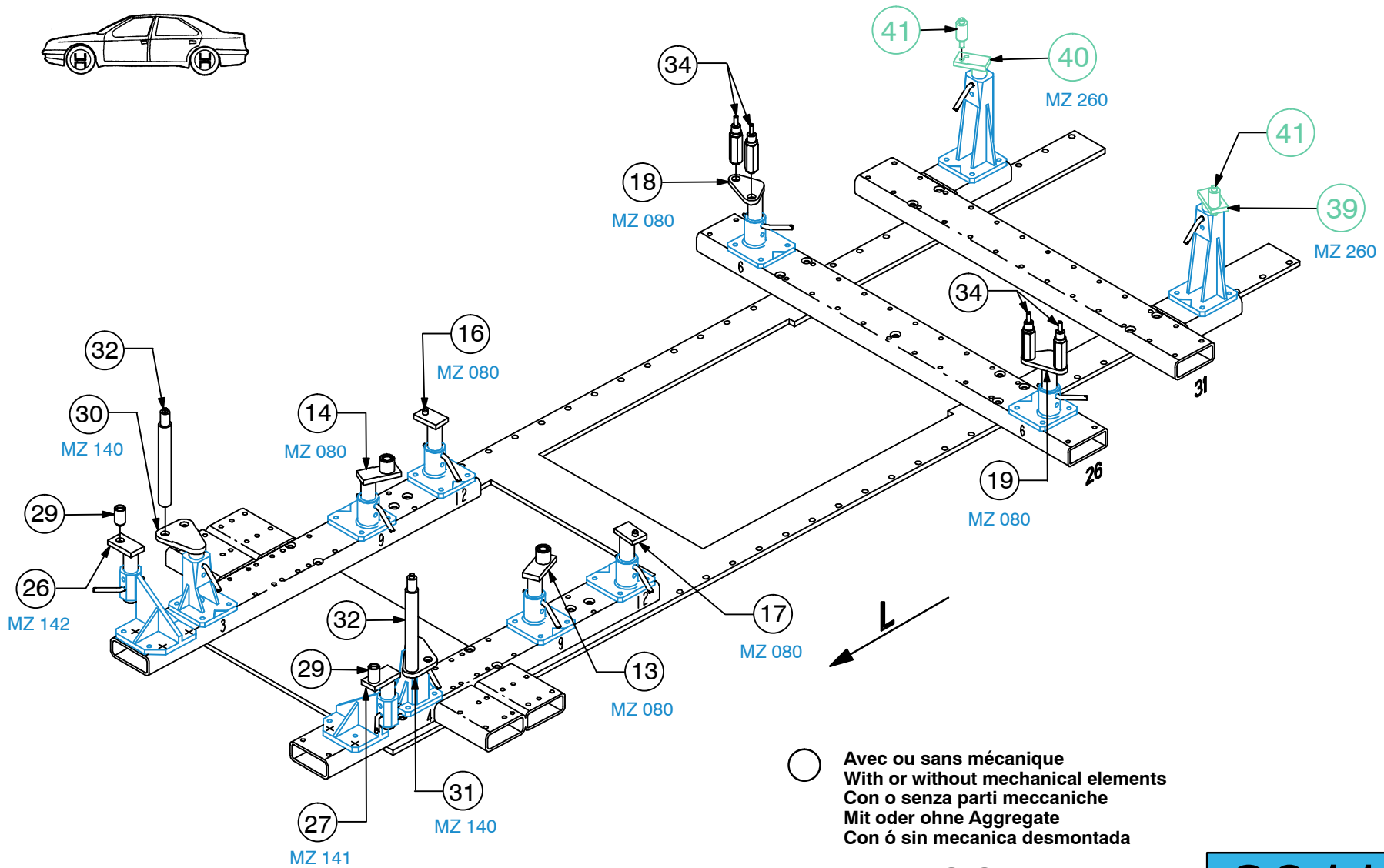

○ Avec ou sans mécanique
 With or without mechanical elements
 Con o senza parti meccaniche
 Mit oder ohne Aggregate
 Con ó sin mecánica desmontada

NISSAN

2011.308
 12 Kg 20.06.2006 410-D-67L

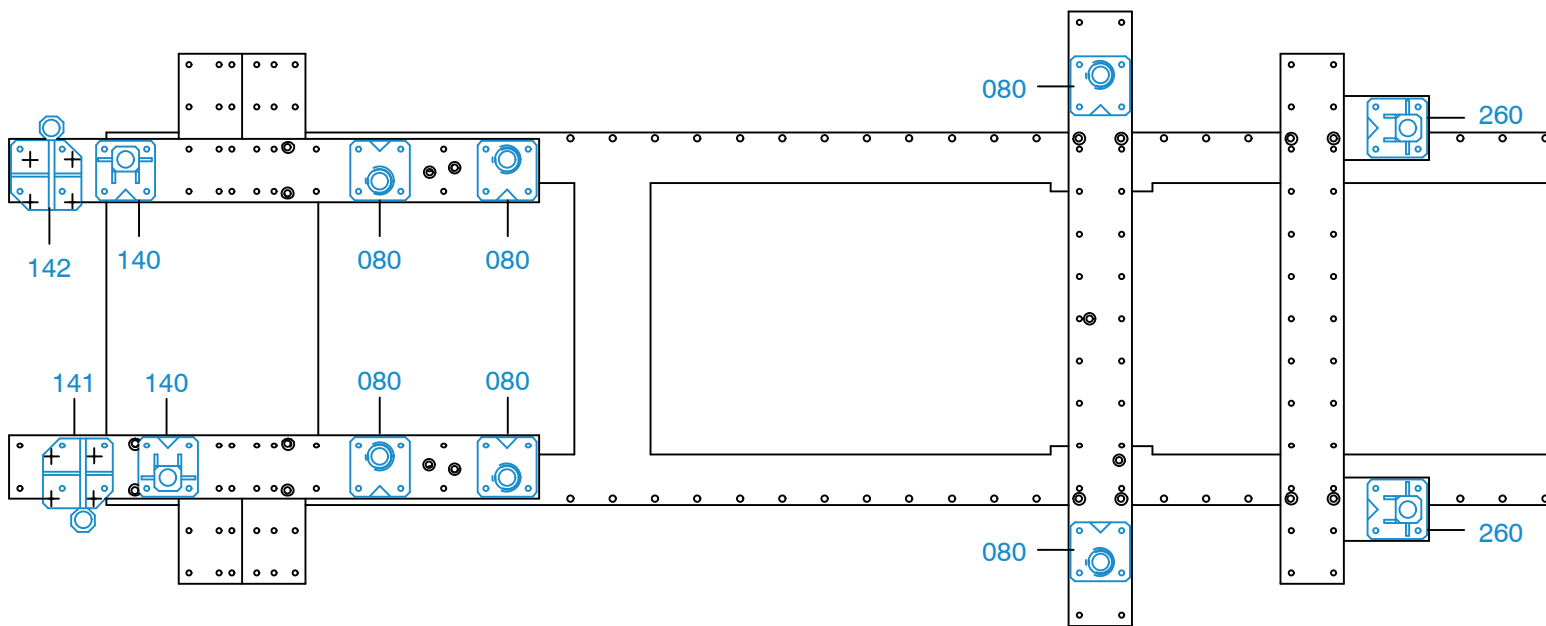

1 2 3 4 5 6 7 8 9 10 11 12 13 14 15 16 17 18 19 20 21 22 23 24 25 26 27 28 29 30 31 32 33 34 35 36

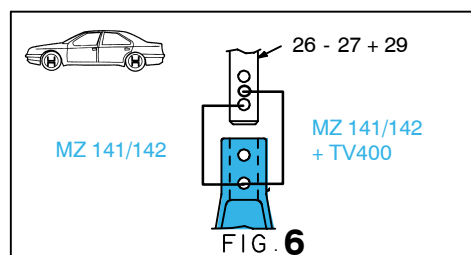
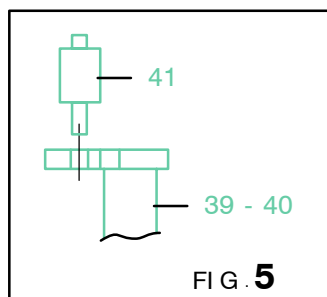
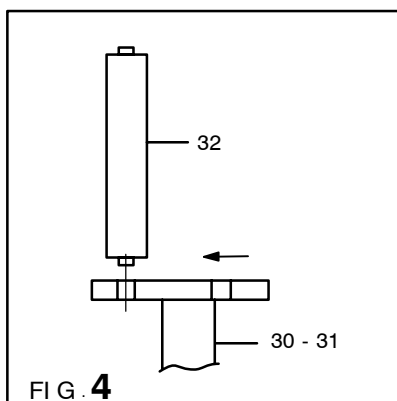



* = Version Europe
N° Série SJN....

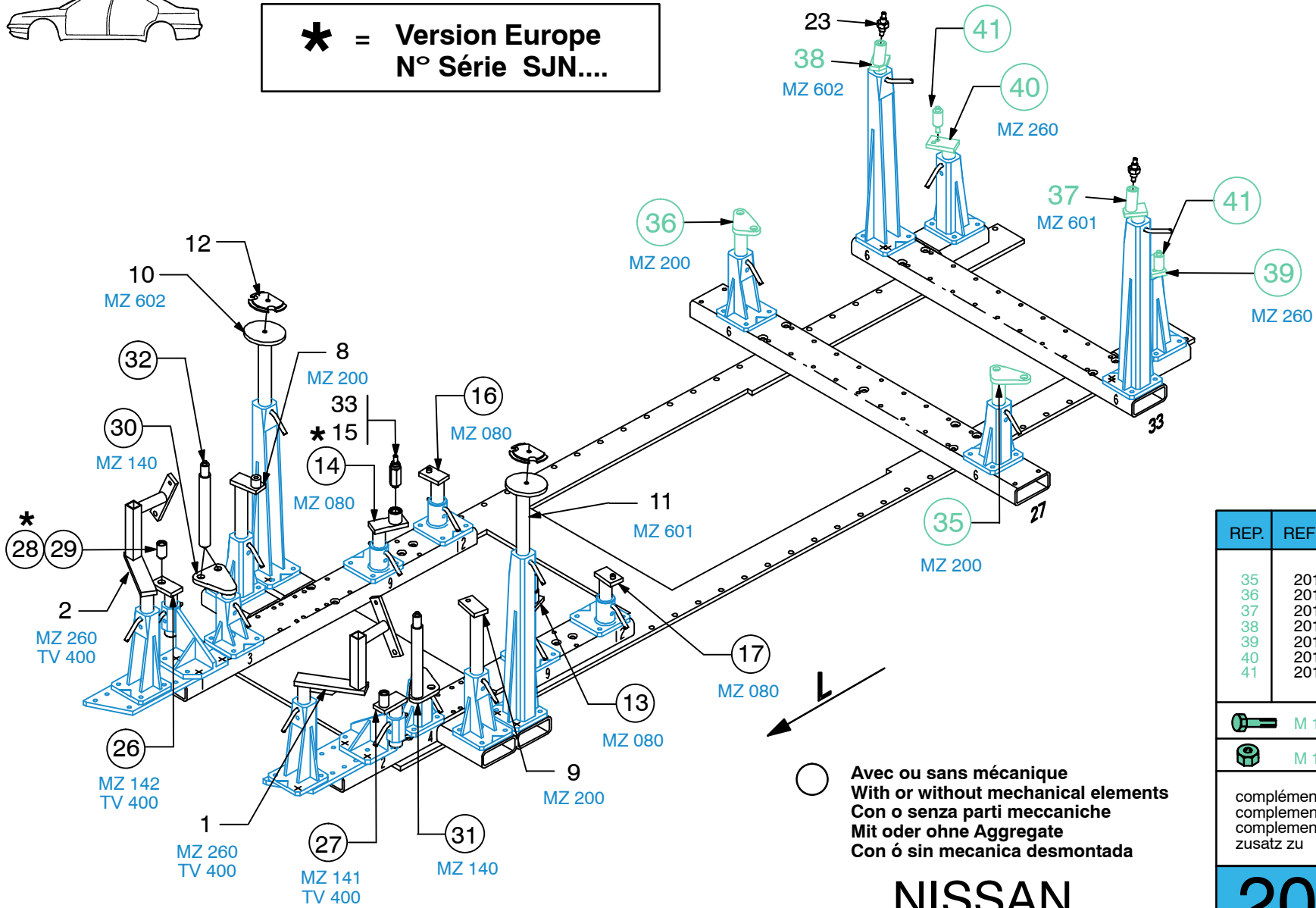

○ Avec ou sans mécanique
With or without mechanical elements
Con o senza parti meccaniche
Mit oder ohne Aggregate
Con ó sin mecanica desmontada

NISSAN

REP.	REFERENCE	PDS	NB	MZ
35	2011.7035	2,3	1	200/080
36	2011.7036	2,3	1	200/080
37	2011.7037	1,8	1	601
38	2011.7038	1,8	1	602
39	2011.7039	1,5	1	260
40	2011.7040	1,4	1	260
41	2011.7041	0,3	2	

	M 10x1,25-30	4
	M 12	2

complément au
complementary set to
complemento al
zusatz zu **2011.310**

2011.308

12 Kg 14.03.2007 410-D-67M

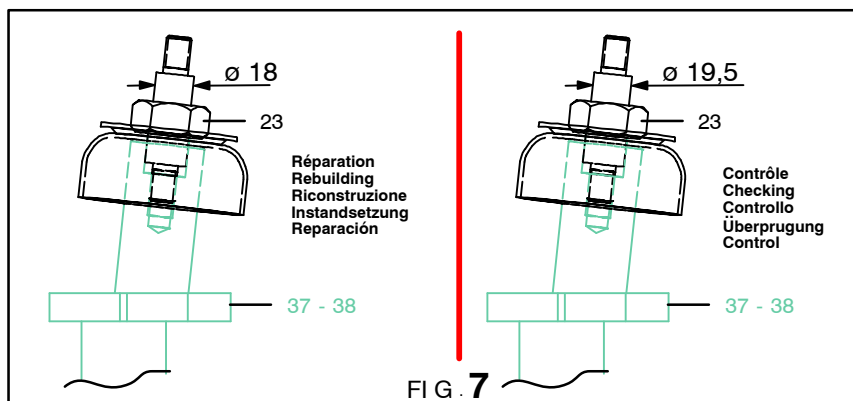
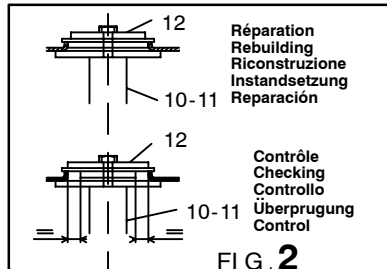
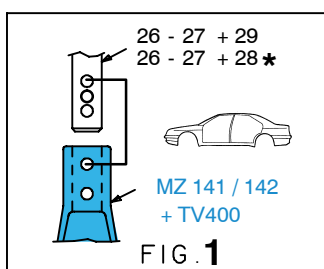
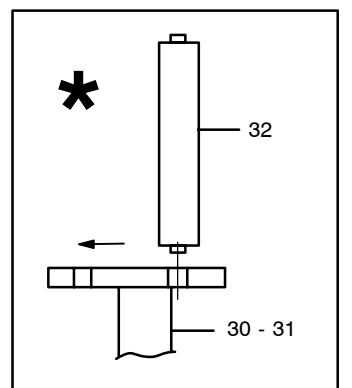
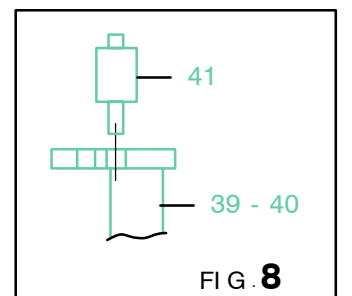
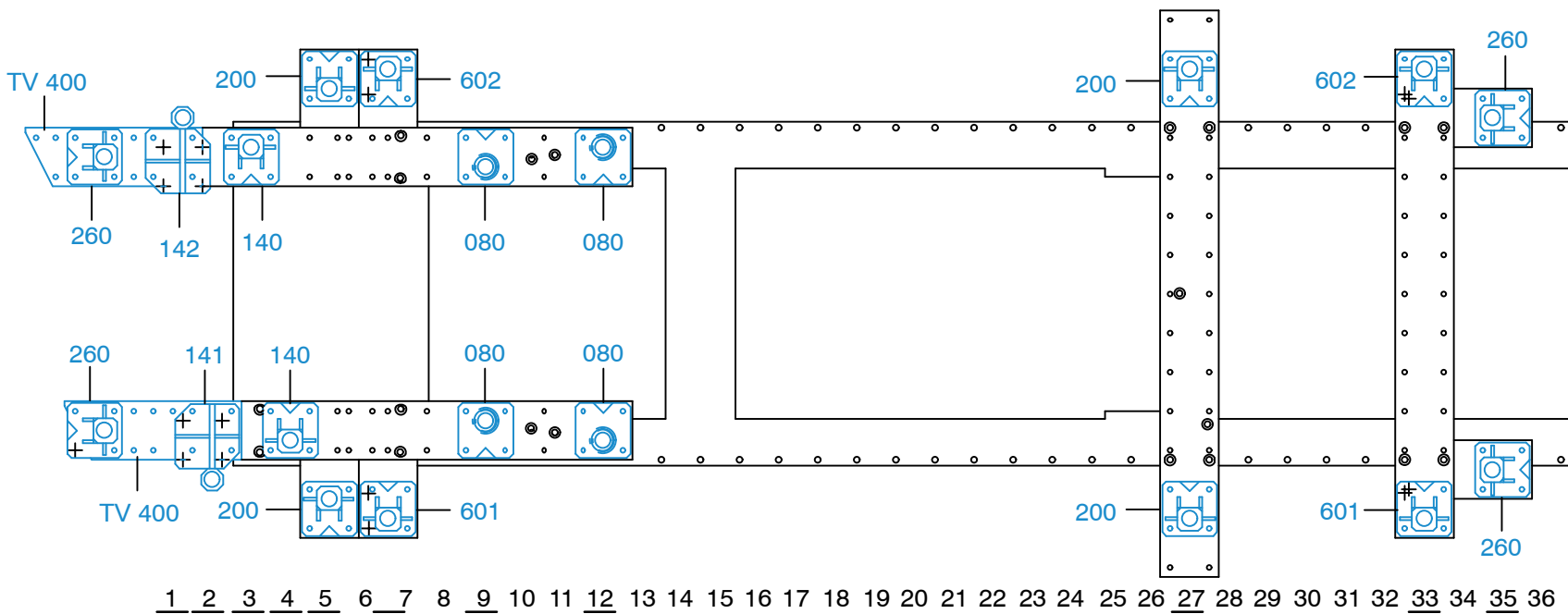

2011.308-RVA3-2 01

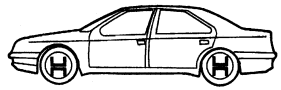

*** = Version Europe
N° Série SJN....**

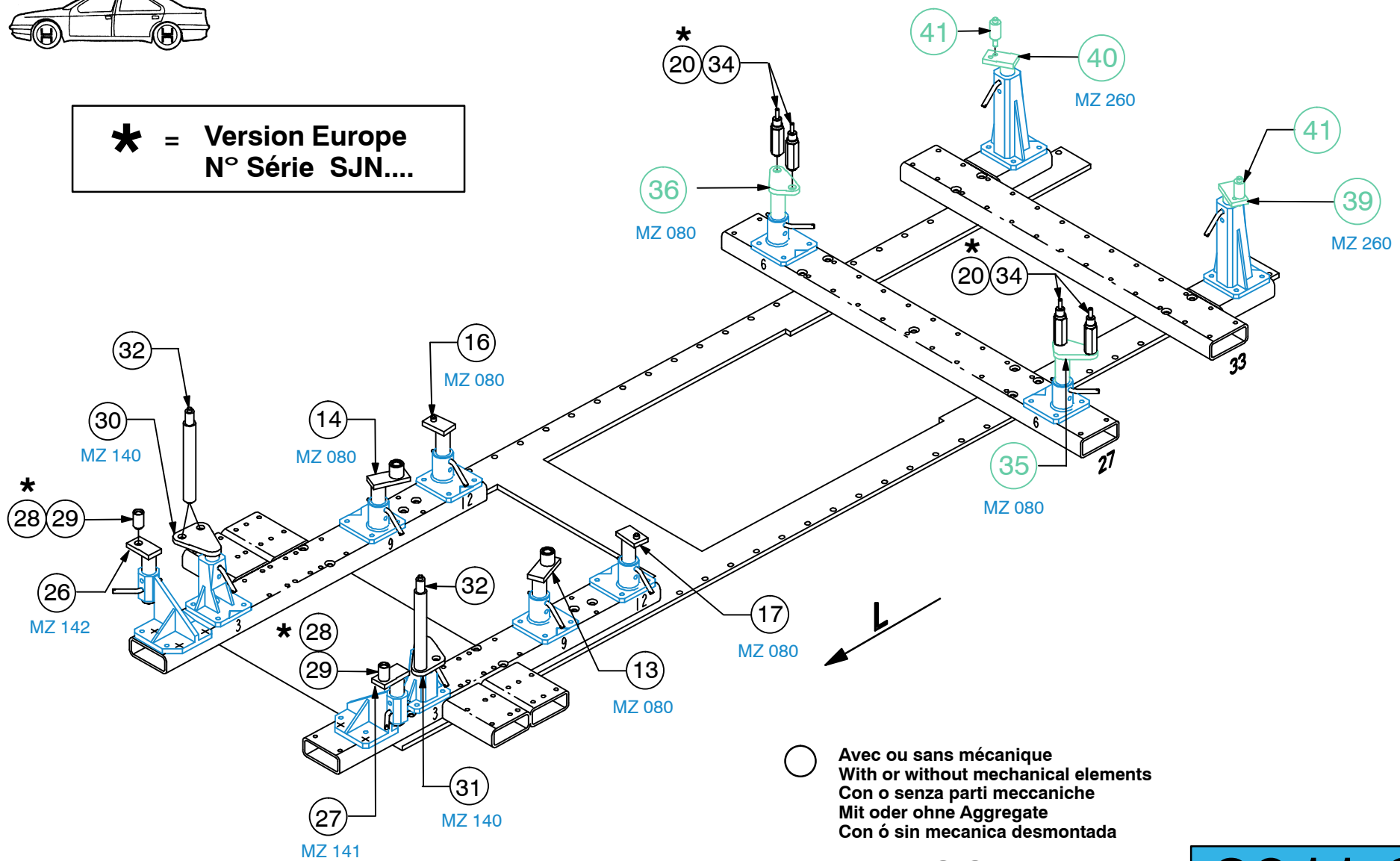

NISSAN

2011.308
12 Kg | 12.06.2007 | 410-D-67N

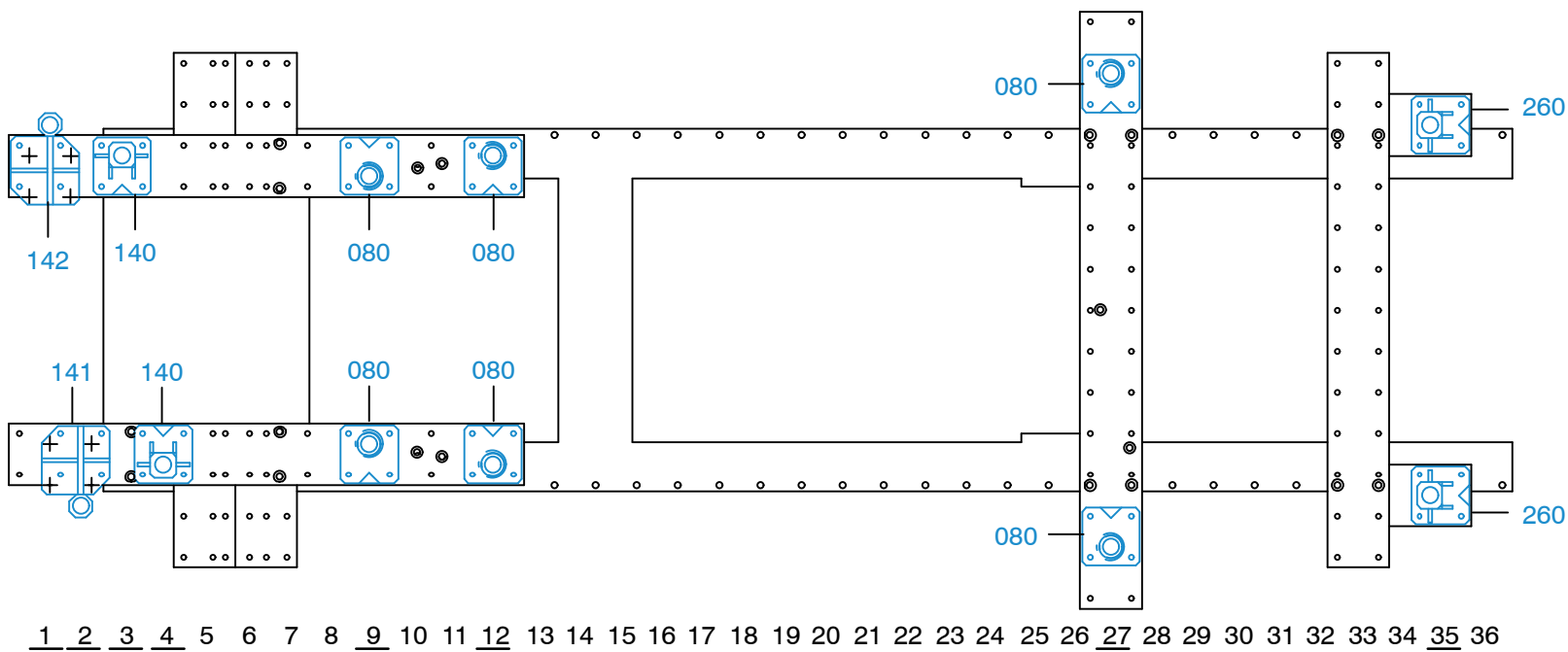

1 2 3 4 5 6 7 8 9 10 11 12 13 14 15 16 17 18 19 20 21 22 23 24 25 26 27 28 29 30 31 32 33 34 35 36

