

○ Avec ou sans mécanique  
With or without mechanical elements  
Con o senza parti meccaniche  
Mit oder ohne Aggregate  
Con ó sin mecanica desmontada

**HONDA**

REP.	REFERENCE	PDS	NB	MZ
1	2006.7001	2,4	1	080
2	2006.7002	2,4	1	080
3	2006.7003	1,9	1	140/080
4	2006.7004	1,9	1	140/080
5	2006.7005	3,8	1	260
6	2006.7006	3,8	1	260
7	2006.7007	2,3	1	601
8	2006.7008	2,3	1	602
9	2006.7009	1,7	1	140/080
10	2006.7010	1,7	1	140/080
11	2006.7011	1,8	1	142
12	2006.7012	1,8	1	141
13	2006.7013	2,0	1	200
14	2006.7014	2,0	1	200
15	2006.7015	1,9	1	140
16	2006.7016	1,9	1	140
17	2006.7017	2,6	1	200
18	2006.7018	2,6	1	200
19	2006.7019	2,4	1	260
20	2006.7020	2,4	1	260
21	2006.7021	2,8	1	200
22	2006.7022	2,8	1	200
23	2006.7023	2,3	1	260
24	2006.7024	2,3	1	260
	D.078	0,5	2	

M 10-30	4
M 12-25	2
M 10x1,25-35	6
M 12x1,25-40	2
M 12x1,25-70	6
M 12x1,25-100	2
M 12x1,25-110	2
M 14x1,50-100	2
M 14x1,50-110	2
M 14x1,50-140	2
M 14x1,50-150	2

M 10	4
------	---

○ Avec ou sans mécanique  
With or without mechanical elements  
Con o senza parti meccaniche  
Mit oder ohne Aggregate  
Con ó sin mecanica desmontada

**2006.300**

58 Kg	05.02.2003	413-D-37A
-------	------------	-----------

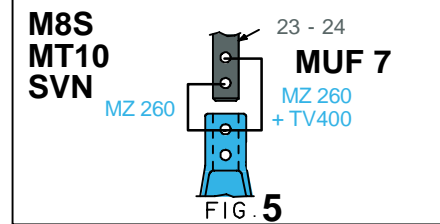
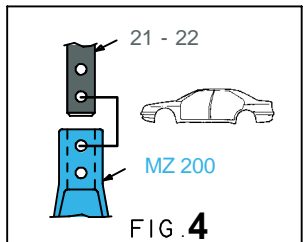
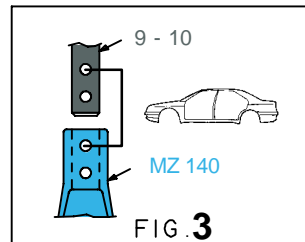
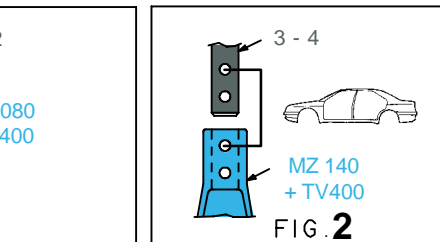
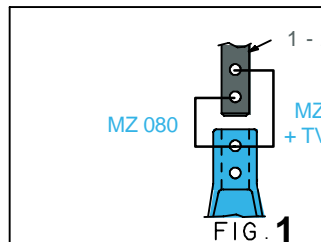
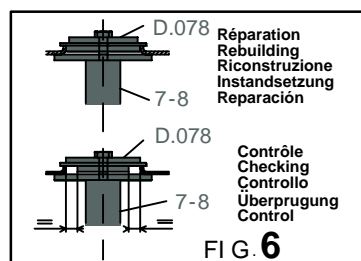
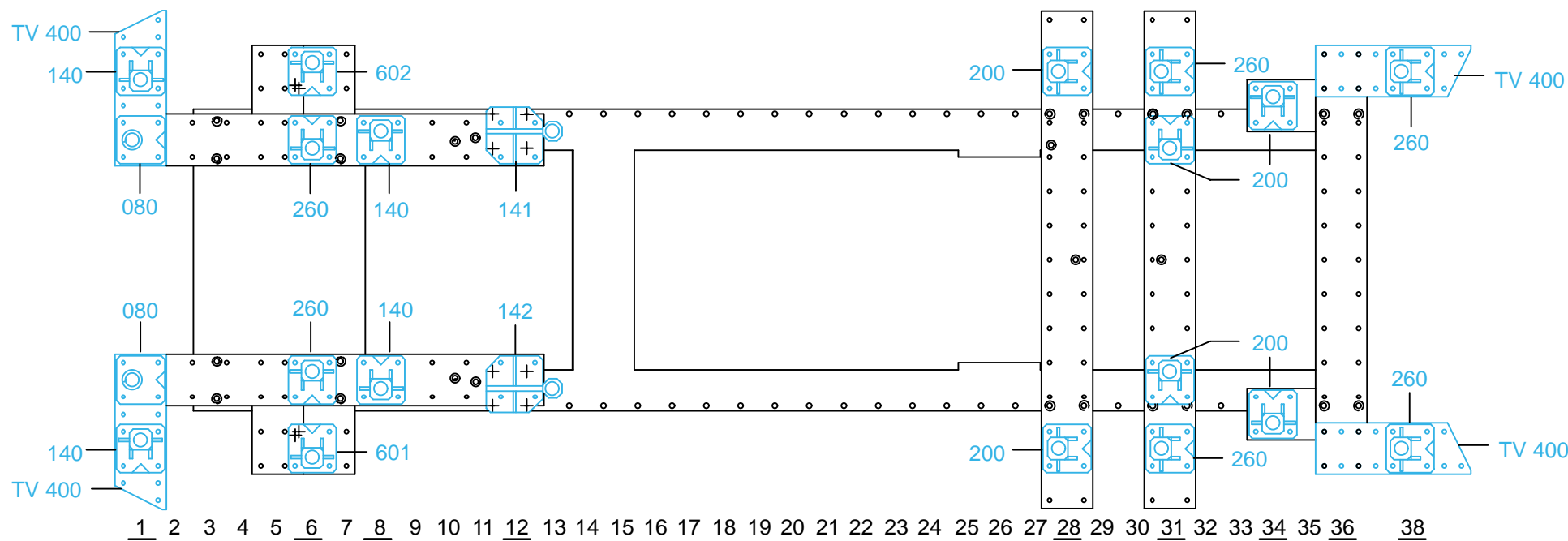

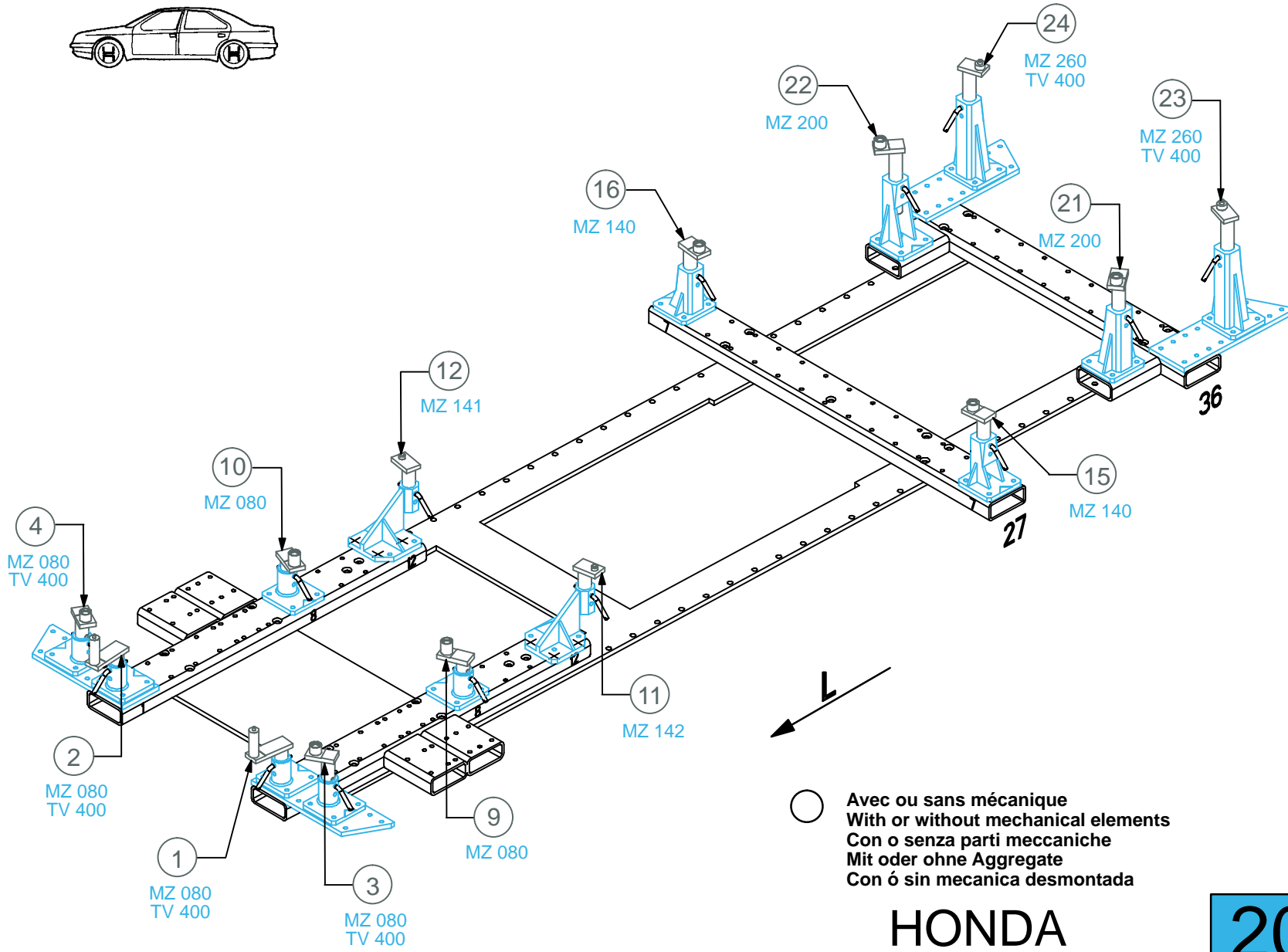
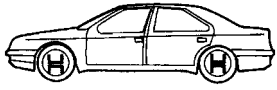

**HONDA**

**2006.300**  
58 Kg | 05.02.2003 | 413-D-37B

